

TERMS OF REFERENCE

- PROJECT TITLE** : **RENTAL OF EXHIBIT COMPONENTS AND SPECIAL PROPS FOR THE BAGSAKAN AT GLORIETTA MALL, MAKATI CITY ON NOVEMBER 27-30, 2020**
- APPROVED BUDGET** : **Php 280,000.00**
- OBJECTIVE** : **To rent exhibit components and special props with the inclusion of delivery / installation / dismantling for the conduct of the Bagsakan on November 27-30, 2020**

A. SPECIFICATIONS:

- 25 sets of props and components for the exhibitors located at the Glorietta Activity Center inclusive of:
 - 1 black carpet, 2.0m x 2.0m
 - 1 convenience outlet, 2-gang
 - 1 display table, 1.20m L x 0.60m W x 0.75 m H, with square metal tube frame and sanded natural wood finish top; covered with wraparound black cloth (4 sides) mounted with black velcro
 - 1 arch table clamp with 3ft T5 LED light (warm white) with wiring inside metal tubing
 - 1 display bench, 1.20m L x 0.30m W x 0.40 m H, with square metal tube frame and sanded natural wood finish top
- *Refer to pages 10 & 13 of full detail drawings***
- 12 sets of props and components for the exhibitors located at the Palm Drive Activity Center inclusive of:
 - 1 black carpet, 3.0m x 3.0m
 - 1 convenience outlet, 2-gang
 - 1 fascia sticker on back to back on foam board, 0.30m x 1.70m
 - 2 pcs. Long arm spot light, warm white
 - 1 display table, 1.20m L x 0.60m W x 0.75 m H, with square metal tube frame and sanded natural wood finish top; covered with wraparound black cloth (4 sides) mounted with black velcro
 - 1 display bench, 1.20m L x 0.30m W x 0.40 m H, with square metal tube frame and sanded natural wood finish top
- *Refer to pages 18 & 19 of full detail drawings***
- Palm Drive Christmas Setting
 - 8 display table, 1.20m L x 0.60m W x 0.75 m H, with square metal tube frame and sanded natural wood finish top
 - 8 display bench, 1.20m L x 0.30m W x 0.40 m H, with square metal tube frame and sanded natural wood finish top

****Refer to pages 17 & 19 of full detail drawings***

- Registration Counter
 - 1 Octanorm system counter, 2.0m W x 0.50m D x 1.00m H with wooden top painted in brown, and sides wrapped with stretched printed tarpaulin (sawali pattern)
 - 2 barstools
 - 2 units T-stand, 1.20m L x 0.30m W x 2.40m H, with graphics printed on tarpaulin (matte side) stretched on frame and long arm spot lights (warm white)

****Refer to page 9 of full detail drawings***

- Logistics Partners Area
 - 1 black carpet, 1.50m x 4.0m
 - 2 system table with 0.5m x 0.5m printed logo on sticker on foamboard
 - 1 T-stand, 0.70m L x 0.20m W x 1.70m H with stretched tarpaulin graphics and (1) long arm spot light, warm white

****Refer to page 11 of full detail drawings***

- Side Entrance Signage
 - 2 units T-stand, 1.20m L x 0.30m W x 2.40m H, with back-to-back graphics printed on Tarpaulin (matte side) stretched on frame and long arm spot lights (warm white)

****Refer to pages 2 & 13 of full detail drawings***

- 39 pcs black stacking chair (monoblock)
- 43 pcs waste bin (25pcs at 2x2m booths / 12pcs at 3x3m booths / 1pc at BDTP counter / 3pcs at Island Bar setting / 2pcs at logistics partners)
- Long arm spot lights, warm white
 - 24 pcs at capiz window stands
 - 12 pcs at Palm Drive Activity Center Entrance Wall (3 units per panel -- 2 at the front and 1 at the back)
 - 24 pcs at 3x3m booths at Palm Drive Activity Center
- Delivery and Installation / Disassembly and Pull out

NOTE: In compliance with Ayala Malls guidelines, (1) all paints/finishes to be used must be fire retardant; and (2) royal cord must be used for wiring.

SCOPE OF WORK

1. The contractor shall supply, install, dismantle and haul the items listed above on the specified materials and specifications
2. The contractor shall coordinate with DTI-BDTP regarding the complete specifications and drawings before the submission of quotation.

3. The contractor shall ensure the durability and quality of the items.
4. The contractor must be willing to accommodate rush printing of graphic requirements.
5. The contractor shall install the items properly and in good condition (without smudge, dirt, and stains and the like) on **November 26, 2020 at 9:00pm to November 27, 2020 at 9:00am, and dismantle it on 30 November 2020 at 9:00pm – 12:00mn.**
6. The contractor shall complete installation of the items at exactly **9:00am on 27 November 2020**
7. **Supervision /Responsibility Fee (SRF) shall be waived by the official booth contractor for those contractors directly contracted by the DTI/organizer.**
8. Delay of delivery or installation and/or non-compliance of specified materials will call for deduction of 10% of contract price unless waived by BDTP Director due to on site changes or circumstances.

TIMETABLE OF ACTIVITIES

- Setup/Installation: November 26-27, 2020 - 9:00pm – 9:00 am.
- Ingress of Exhibitors: November 27, 2020 – 6:00 am.- 9:00 am.
- Event Proper: November 27-30, 2020 - 10:00am – 9:00pm.
- Egress/Dismantling: November 30, 2020 – 9:00pm. – 12:00 mn

TERMS OF PAYMENT

- Full payment 30 days after the conclusion of the event.

QUALIFICATION CRITERIA

- Must have a satisfactory record of performance with no derogatory finding from previous clients
- Submission of SUPPLIERS' ACCREDITATION REQUIREMENTS, Please attach photocopies of the ff:
 1. SEC, DTI Business Permit, Articles of Incorporation or Partnership (in case of corporation/partnership)
 2. Mayor's Permit for the Current Year
 3. BIR Certificate of Registration
 4. PhilGEPS Certification
 5. Company Profile
 6. Tax Clearance for the Current Year

Prepared by:

GERARDO E. RAVELAS
STIDS, BDTP

Noted by:

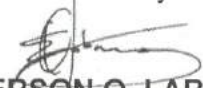
EMERSON Q. LABANG
Supervising TIDS, MDPD

Approved by:

MARIEVIC M. BONOAN
Director, BDTP

TERMS OF REFERENCE

- PROJECT TITLE** : REPAIR / RESTORATION / REPAINTING / DELIVERY / INSTALLATION / DISMANTLING OF EXISTING BDTP EXHIBIT PROPS/MODULES AND SETTINGS TO BE USED AT THE BAGSAKAN AT GLORIETTA MALL ON NOVEMBER 27-30, 2020
- APPROVED BUDGET** : Php 300,000.00
- OBJECTIVE** : To repair / restore / repaint / deliver / install / dismantle existing BDTP exhibit props/modules and settings for the conduct of the Bagsakan on November 27-30, 2020

SPECIFICATIONS:

1. Pinoy Island Bar Setting
 - Wooden structure with coco wood framing, bamboo slats backwall and anahaw/nipa roofing
 - 2 units, wood burnt signage 2.0m x 0.35m
 - 6 units, wooden shelves, 0.90mx0.20m
 - 3 units, low display table 0.30m x 0.60m x 0.60m H
 - 2 units, wooden fence type planter boxes with potted plants
 - 2 units, bamboo hanging lamps
 - 3 convenience outlet
 - 12 units 5W black track lights warm white
 - 6 pcs. Long arm spot lights, warm white
 - 5.0m x 3.0m x 0.10m platform covered with jute fabric

****Refer to page 7 of full detail drawings***
2. 1 unit capiz window stand with 2pcs matte sticker graphics 2.40m L x 0.30m W x 2.54m Height
3. 4 units capiz window stand 1.20m L x 0.30m W x 2.54 H

****Refer to page 12 of full detail drawings***

4. 32 units Display shelving, 0.35m x 0.60m x 1.60m H (25pcs for 2x2m booths / 4pcs for Island Bar setting / 3pcs for Christmas setting)

****Refer to page 13 of full detail drawings***

5. 10 units Low Display shelving 0.50m L x 0.60m W x 1.0m H (for 3x3m booths)

****Refer to page 13 of full detail drawings***

6. 5 units Display Table 0.60m L x 0.30m W x 0.60m H (3pcs for Island Bar Setting / 2pcs for Christmas Setting)
****Refer to page 13 of full detail drawings***
7. 22 units, foldable wooden racks, 0.50m x 1.10m H
****Refer to page 14 of full detail drawings***
8. 10 units, wooden planters in natural finish (6pcs at capiz window stands / 4pcs at Palm Drive Activity Center entrance)
9. Palm Drive Christmas Setting
 - 12.0m x 6.0m black carpet
 - 2 units of existing structure 4.50m x 4.50m x 2.40m H
 - 2 units of 4.50m x 4.50m x 0.10m H triangular platform in black carpet
 - 8 convenience outlet
 - 12 units black track lights, warm white****Refer to page 17 of full detail drawings***
10. Delivery and Installation / Disassembly and Pull out

NOTE: In compliance with Ayala Malls guidelines, (1) all paints/finishes to be used must be fire retardant; and (2) royal cord must be used for wiring.

SCOPE OF WORK

1. The contractor shall Repair, Supply, Haul, Install, Dismantle and bring back all the items listed above on the specified materials and specifications
2. The contractor shall coordinate with DTI-BDTP regarding the complete specifications and drawings before the submission of quotation.
3. The contractor shall ensure the durability and quality of the items.
4. The contractor must be willing to accommodate rush printing of graphic requirements.
5. The contractor shall install the items properly and in good condition (without smudge, dirt, and stains and the like) on **November 26, 2020 at 9:00pm to November 27, 2020 at 9:00am, and dismantle it on 30 November 2020 at 9:00pm – 12:00mn.**
6. The contractor shall complete installation of the items at exactly **9:00am on 27 November 2020**
7. **Supervision /Responsibility Fee (SRF) shall be waived by the official booth contractor for those contractors directly contracted by the DTI/organizer.**
8. Delay of delivery or installation and/or non-compliance of specified materials will call for deduction of 10% of contract price unless waived by BDTP Director due to on site changes or circumstances.

TIMETABLE OF ACTIVITIES

- Setup/Installation: November 26-27, 2020 - 9:00pm – 9:00 am.
- Ingress of Exhibitors: November 27, 2020 – 6:00 am.- 9:00 am.
- Event Proper: November 27-30, 2020 - 10:00am – 9:00pm.
- Egress/Dismantling: November 30, 2020 – 9:00pm. – 12:00 mn

TERMS OF PAYMENT

- Full payment 30 days after the conclusion of the event.

QUALIFICATION CRITERIA

- Must have a satisfactory record of performance with no derogatory finding from previous clients
- Submission of SUPPLIERS' ACCREDITATION REQUIREMENTS, Please attach photocopies of the ff:
 1. SEC, DTI Business Permit, Articles of Incorporation or Partnership (in case of corporation/partnership)
 2. Mayor's Permit for the Current Year
 3. BIR Certificate of Registration
 4. PhilGEPS Certification
 5. Company Profile
 6. Tax Clearance for the Current Year

The contractor has the responsibility to assemble, install and freight to site "Glorietta Mall, Activity Center, Makati City", disassemble and freight to site" BUREAU OF DOMESTIC TRADE PROMOTION, G/F, TRADE AND INDUSTRY BLDG., 361 SEN. GIL PUYAT AVENUE, MAKATI CITY".

Prepared by:

RODEL E. DEL ROSARIO
ADMINAID VI, MDPD

Noted by:

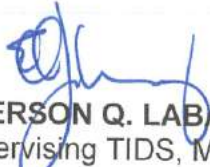
EMERSON Q. LABANG
Supervising TIDS, MDPD

Approved by:

MARIEVIC M. BONOAN
Director, BDTP

TERMS OF REFERENCE

PROJECT TITLE : Fabrication/delivery/installation/dismantling of the Bagsakan Pillars/Facade, Sanitizing Stations and other props to be used on November 27-30, 2020 at Glorietta Mall, Makati City

APPROVED BUDGET : Php 400,000.00

OBJECTIVE : To fabricate/deliver/install/dismantle the Entrance Pillars/Façade, Sanitizing Stations and other props for the conduct of of the Bagsakan on November 27-30, 2020

SPECIFICATIONS:

1. GLORIETTA ACTIVITY CENTER ENTRANCE / EXIT

- 10 units, wooden pillars 0.75cm W x 0.75cm L x 2.40 H made of sanded wood pallets
- 1 wood print sticker graphics on plywood, 3.50m W x 6.0m L
- 1 black carpet flooring, 6.0m x 6.0m
- 10 units, LED flood lights (warm white)
- 1 lot, capiz star string lights (natural color with warm white bulbs using royal cord)

**Refer to pages 5-6 & 14 of full detail drawings*

2. PALM DRIVE ACTIVITY CENTER ENTRANCE

- 2 units 0.40m W x 1.65m L x 1.62m H Paleta/palochina back wall with plant box
- 2 units 0.40m W x 1.65m L x 1.87m (2.40m) H Paleta/palochina back wall with plant box and extended wood for hanging capiz star string lights
- 1 lot, capiz star string lights (natural color with warm white bulbs using royal cord)
- 1.0m x 1.50m matte sticker graphics on foam board

**Refer to page 16 of full detail drawings*

3. 3x3m BOOTH AT PALM DRIVE ACTIVITY CENTER

- 12 units, pallet slatted backwall with shelves painted in white, 2.0m W x 0.5m D x 1.83m H

**Refer to pages 18-19 of full detail drawings*

4. DISPLAY SHELVES/TABLES COMPONENTS

- 29 pcs Clip-on Steel Signage Holder, 0.60m x 0.20m, painted in black

- 29 pcs fascia sticker on back-to-back on foam board, 0.50m x 0.12m H, hung with jute strings (for 2x2m booths)

****Refer to pages 10 & 13 of full detail drawings***

5. 5 units display shelving, 0.35m x 0.60m x 1.60m H, with square metal tube frame and sanded natural wood finish top
****Refer to page 13 of full detail drawings***
6. 2 units, low display shelving, 0.50m L x 0.60m W x 1.0m H, with square metal tube frame and sanded natural wood finish top
****Refer to page 18-19 of full detail drawings***
7. 86 pcs, vinyl traffic flow arrow floor stickers (orange), 0.25m L x 0.20m W (56pcs for Glorietta Activity Center / 30pcs for Palm Drive Activity Center)
****Refer to pages 20 & 23-24 14 of full detail drawings***
8. 6 units, automatic alcohol dispenser with black metal stand
****Refer to page 6 of full detail drawings***
9. 1 lot assorted hanging plants (60pcs for pillars / 6pcs for Island Bar / 12pcs for Palm Drive Activity Center entrance)
10. 1 lot assorted decorative plants (18-20 pots)
11. 50 pcs, black booth cover, 2.50 m L x 2.0 m W, with silkscreen print of DTI-BDTP logo (25pcs for 2x2 booths / 12pcs for 3x3 booths / 9pcs for Christmas setting / 4pcs for Island Bar setting)
****Refer to page 20 of full detail drawings***
12. 4 sets, wooden easel (adjustable height to at least 5ft) with matte sticker on 1.5mm sintra board poster (71cm x 81cm)
13. Delivery and Installation / Disassembly and Pull out

NOTE: In compliance with Ayala Malls guidelines, (1) all paints/finishes to be used must be fire retardant; and (2) royal cord must be used for wiring.

SCOPE OF WORK

1. The contractor shall coordinate with DTI-BDTP regarding the complete specifications and drawings before the submission of quotation.
2. The contractor shall supply, install, dismantle and haul the items listed above on the specified materials and specifications
3. The contractor shall ensure the durability and quality of the items.
4. The contractor must be willing to accommodate rush printing of graphic requirements.

5. The contractor shall install the items properly and in good condition (without smudge, dirt, and stains and the like) on **November 26, 2020 at 9:00pm to November 27, 2020 at 9:00am**, and dismantle it on **30 November 2020 at 9:00pm – 12:00mn**.
6. The contractor shall complete installation of the items at exactly **9:00am on 27 November 2020**
7. **Supervision /Responsibility Fee (SRF) shall be waived by the official booth contractor for those contractors directly contracted by the DTI/organizer.**
8. Delay of delivery or installation and/or non-compliance of specified materials will call for deduction of 10% of contract price unless waived by BDTP Director due to on site changes or circumstances.

TERMS OF PAYMENT

- Full payment 30 days after the conclusion of the event.

QUALIFICATION CRITERIA

- Must have a satisfactory record of performance with no derogatory finding from previous clients
- Submission of SUPPLIERS' ACCREDITATION REQUIREMENTS, Please attach photocopies of the ff:
 1. SEC, DTI Business Permit, Articles of Incorporation or Partnership (in case of corporation/partnership)
 2. Mayor's Permit for the Current Year
 3. BIR Certificate of Registration
 4. PhilGEPS Certification
 5. Company Profile
 6. Tax Clearance for the Current Year

The contractor has the responsibility to assemble, install and freight to site "Glorietta Mall, Acitivity Center, Makati City", disassemble and freight to site "BUREAU OF DOMESTIC TRADE PROMOTION, G/F, TRADE AND INDUSTRY BLDG., 361 SEN. GIL PUYAT AVENUE, MAKATI CITY".

Prepared by:



GERARDO E. RAVELAS
STIDS, BDTP

Noted by:

EMERSON Q. LABANG
Supervising TIDS, MDPD

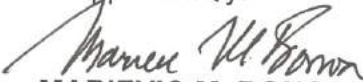
Approved by:

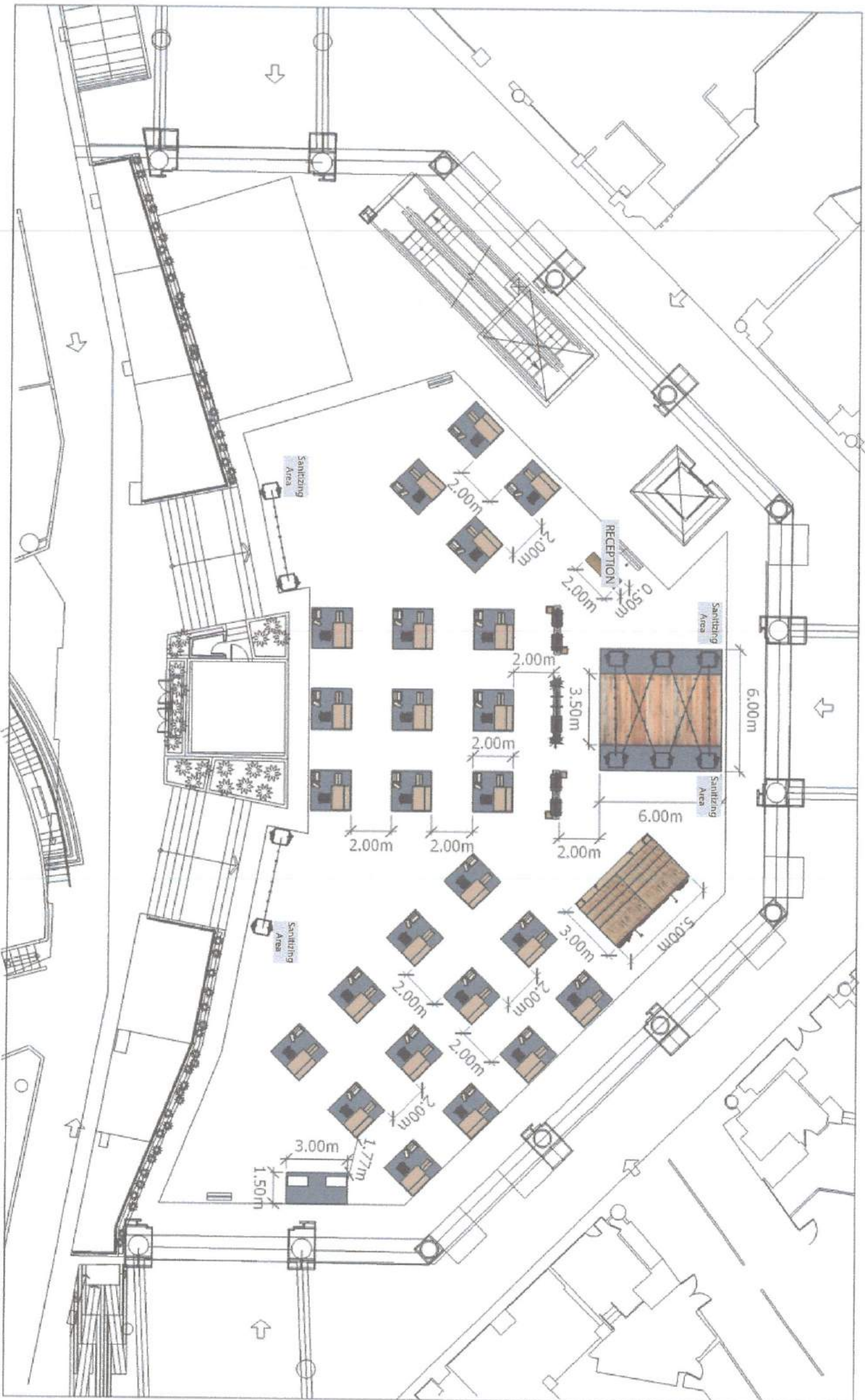
MARIEVIC M. BONOAN
Director, BDTP



T-STAND 1.20m l x 0.30m w x 2.40m h
- going to sm

T-STAND 1.20m l x 0.30m w x 2.40m h
- going to landmark

T-STAND
1.20m l x 0.30m w x 2.40m h
- registration



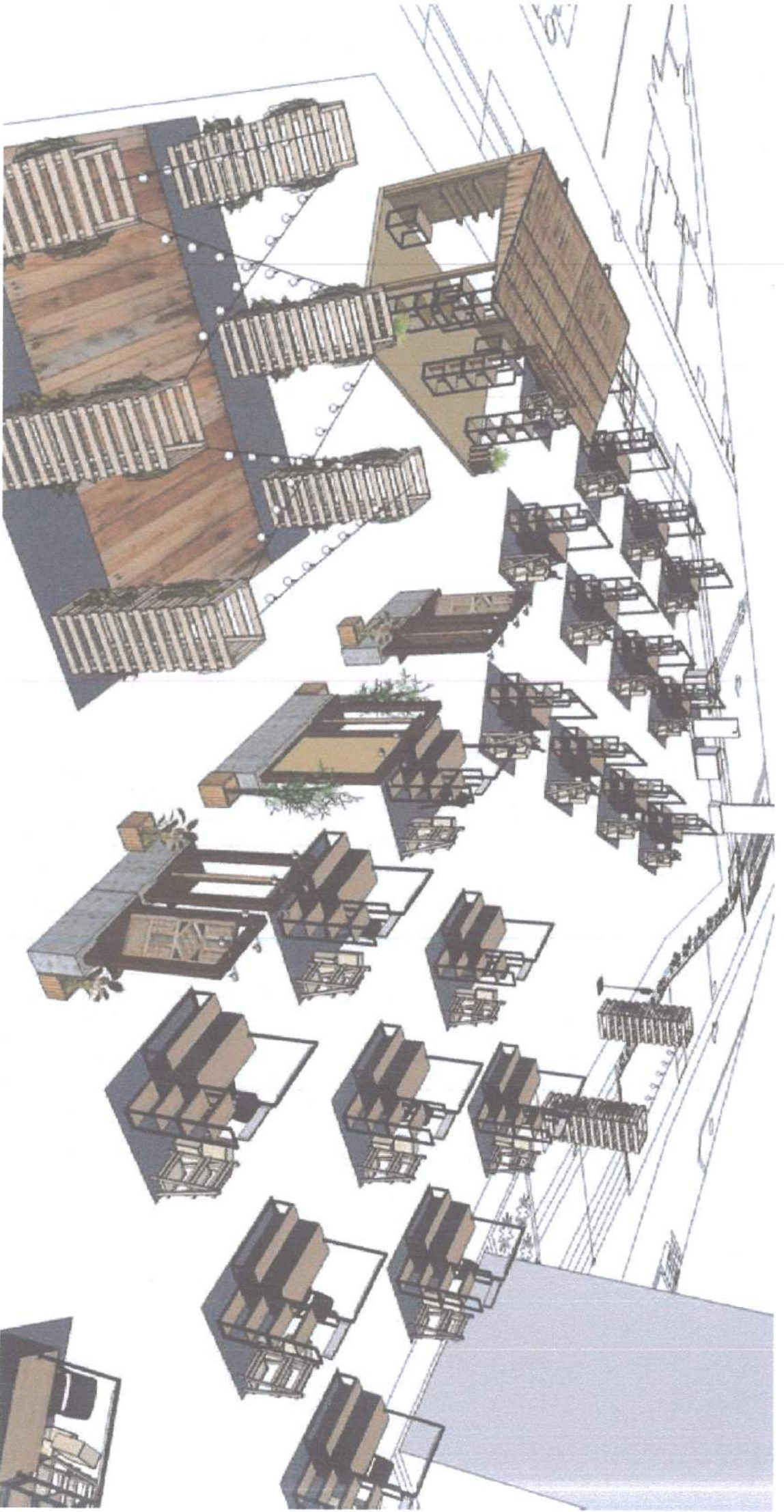

T-STAND 1,20m l x 0,30m w x 2,40m h
-going to landmark

Sanitizer stand

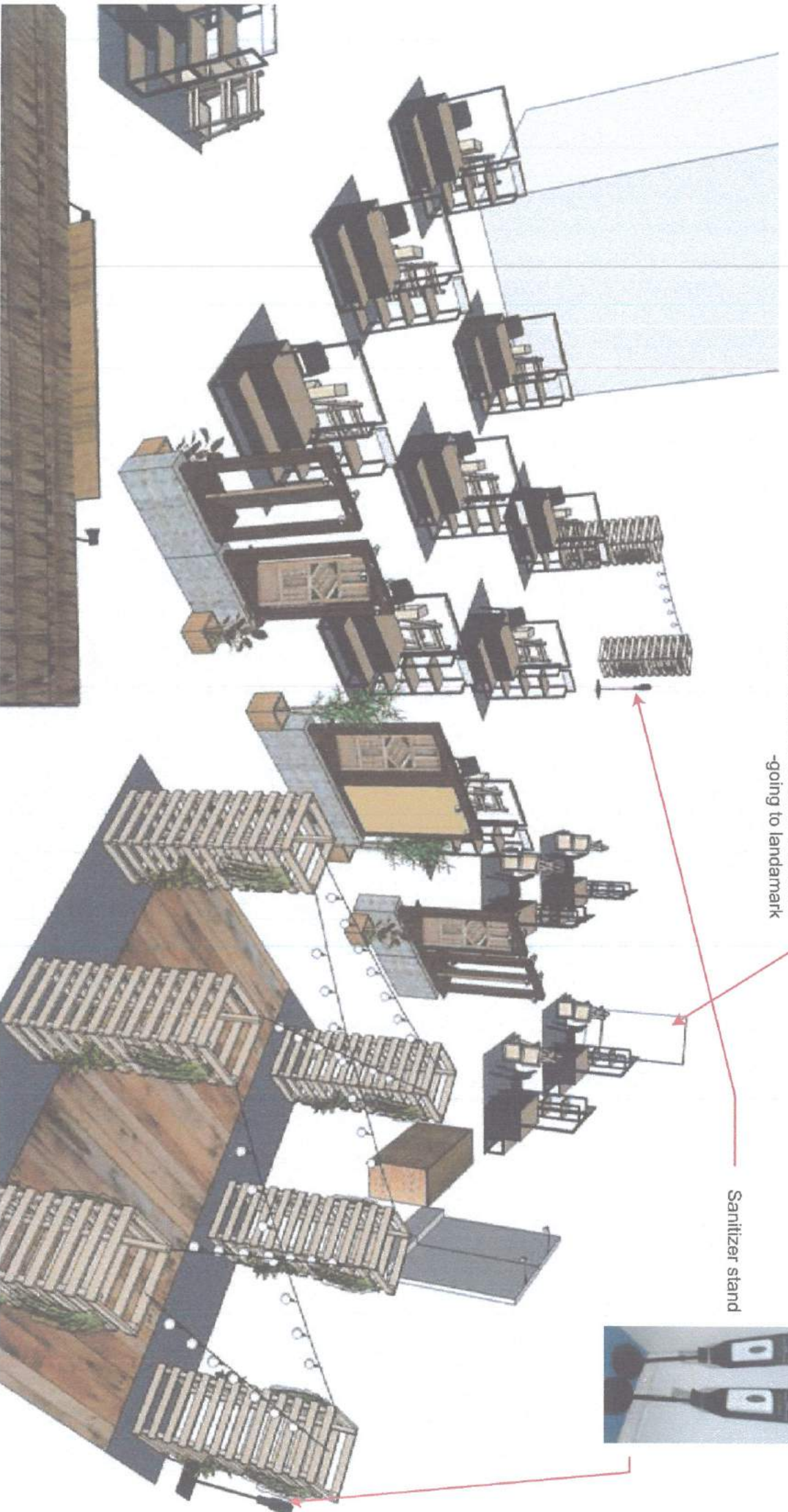
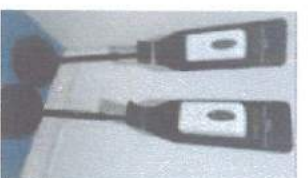

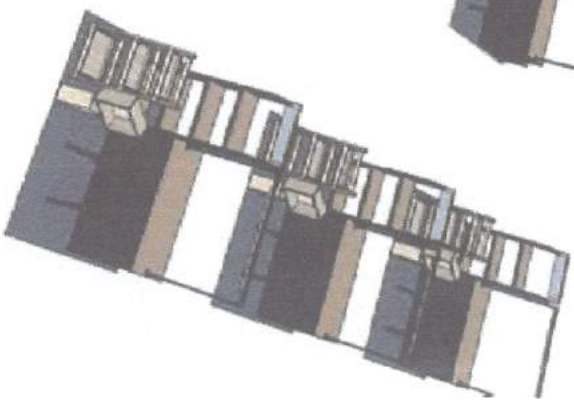
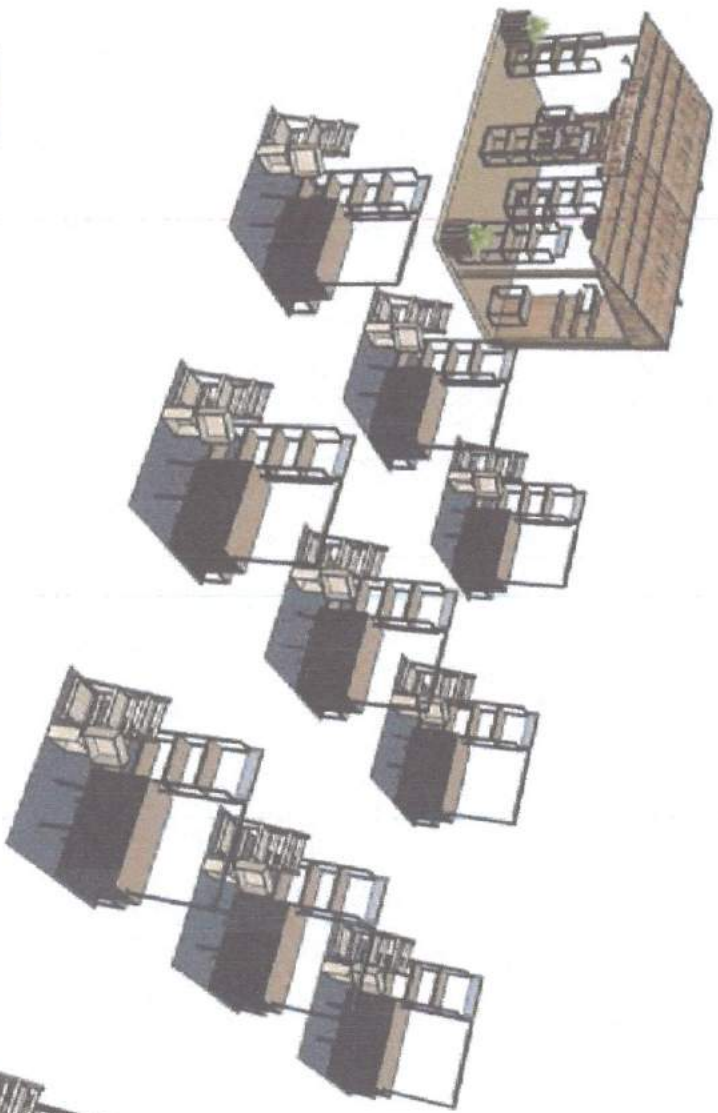

Capiz Star string lights



0.75m W x 0.75m L x 2.40m H
Pillars made of sanded wood pallets,
with hanging plants and floor spot lights in side



Capiz Star string lights

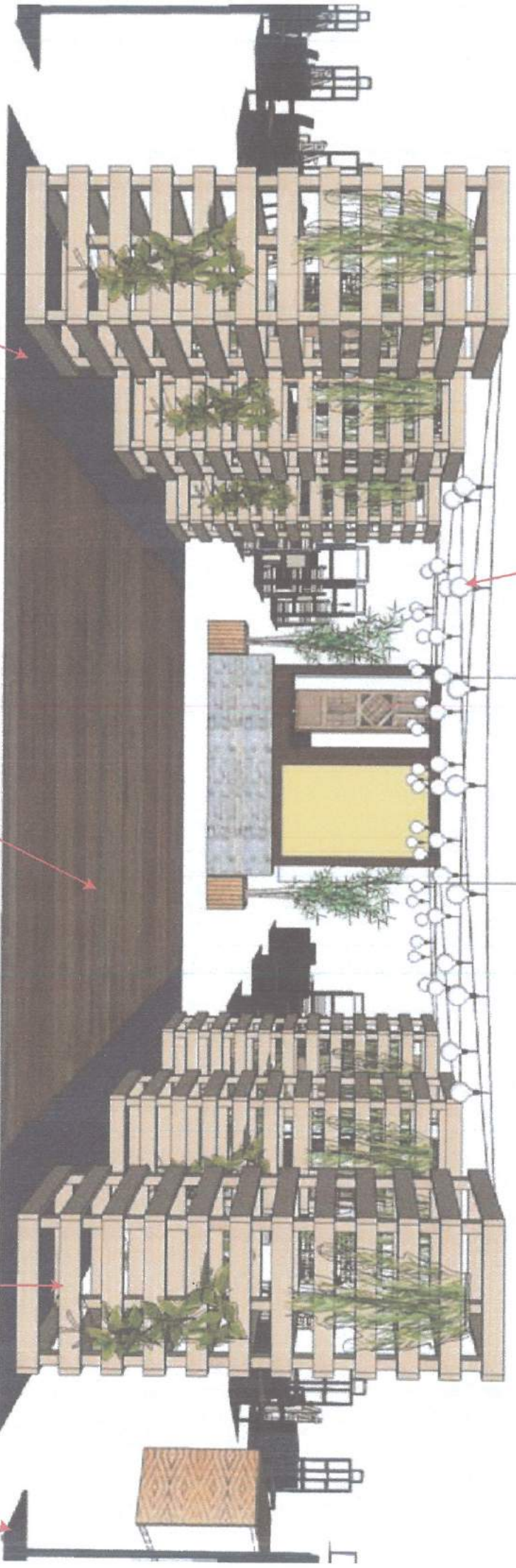

6.0m W x 6.0m L
Black carpet

3.50m W x 6.0m L
Wood Print Sticker graphics

0.75m W x 0.75m L x 2.40m H
Pillars made of sanded wood pallets,
with hanging plants and floor spot lights in side

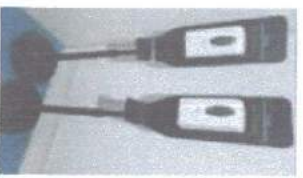

Sanitizer stand



INCLUSIVE OF:

- Wooden Structure with coco wood framing, bamboo slats back wall, and anahaw/niipa roofing
- 2 wood burnt signage, 2.0m x 0.35 m
- 6 wooden shelves, 0.90m x 0.20m
- 3 Low Display table 0.30m x 0.60m x 0.60m H
- 4 Display shelving 0.35m x 0.60m x 1.60m H
- 4 0.60m x 0.20m H Steel signage holder
- 4 0.50m x 0.12m H fascia sticker on back-to-back on foam board
- 2 wooden fence type planter boxes with potted plants
- 2 bamboo hanging lamps
- 3 convenience outlet
- 12 units 5W black track lights, warm white
- 4 pcs long arm halogen light, warm white
- Wall / hanging plants
- 5.0m x 3.0m x 0.10m platform covered with jute fabric
- 3 waste bins
- 6 black booth cover with DTI BDTP logo

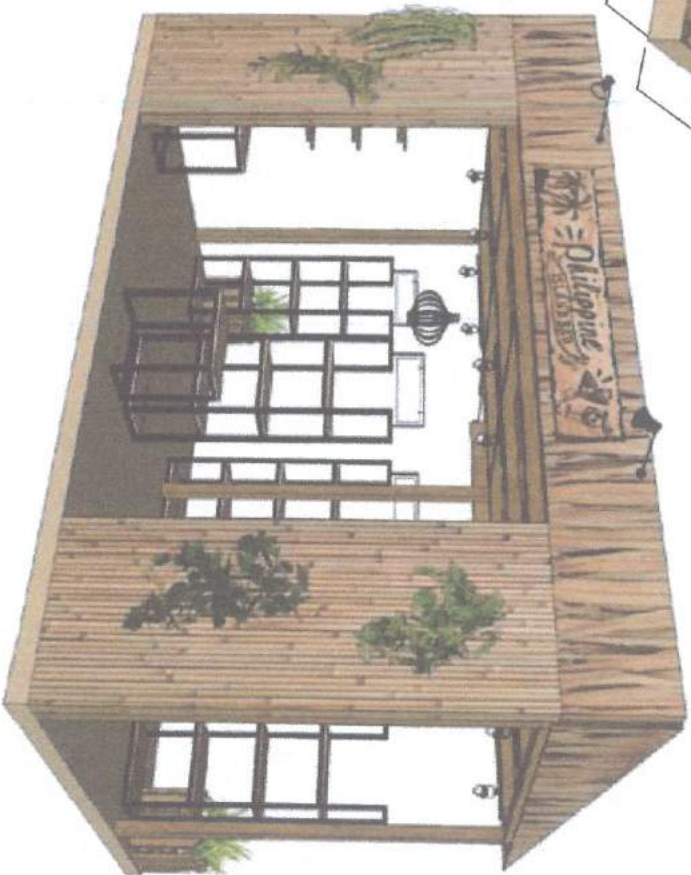

DTI-BAGSAKAN November 2020
ACTIVITY CENTER LAYOUT_PINOY ISLAND SETTING
 AS OF 11 NOVEMBER

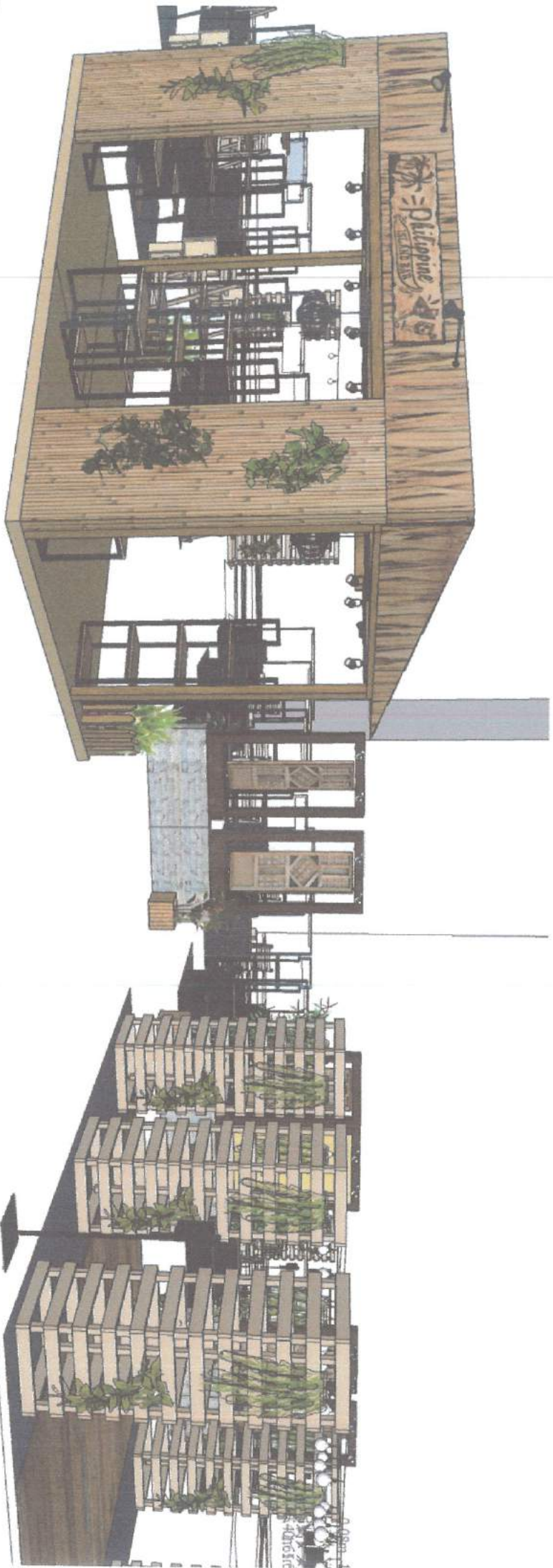

DTI-BAGSAKAN November 2020
ACTIVITY CENTER LAYOUT_PINOY ISLAND SETTING
AS OF 08 NOVEMBER

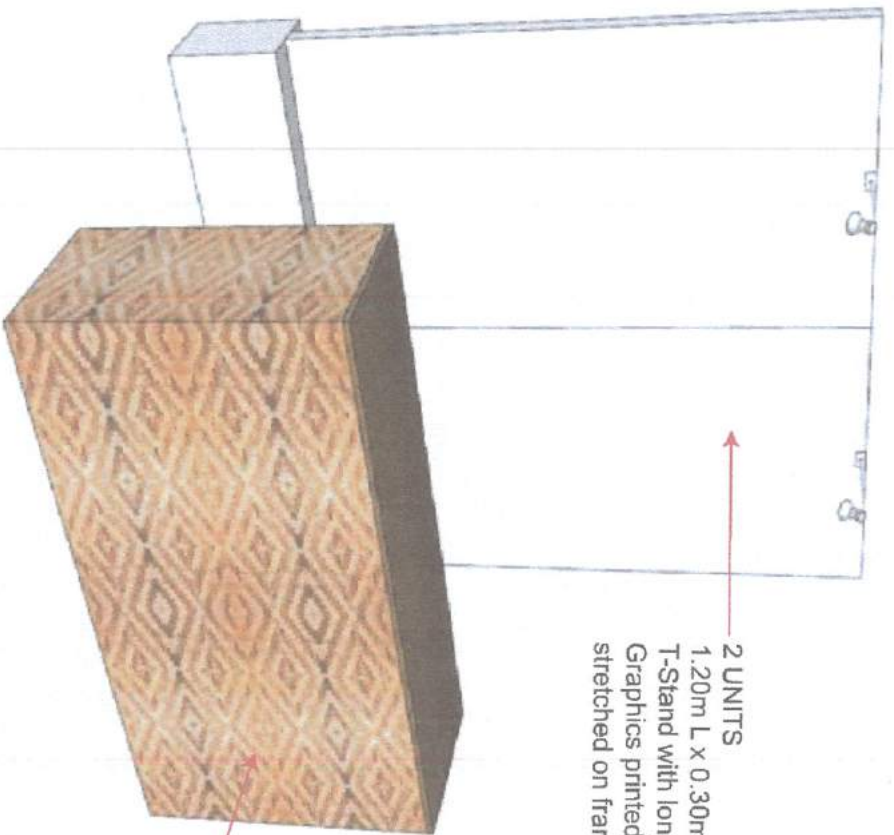

2 UNITS
 1.20m L x 0.30m W x 2.40m H
 T-Stand with long arm spot light;
 Graphics printed on Tarpaulin (matte side)
 stretched on frame

REGISTRATION COUNTER

2.0m x 0.50m x 1.00m Ht
 Counter (octanorm system) wood counter top
 painted in brown C40 M55 Y61 K52

and side in SAWALL Pattern
 Graphics printed on Tarpaulin (matte side)
 stretched on frame

Display shelving
0.35m x 0.60m x 1.60m H

Display bench
1.20m L x 0.30m W x 0.40m H

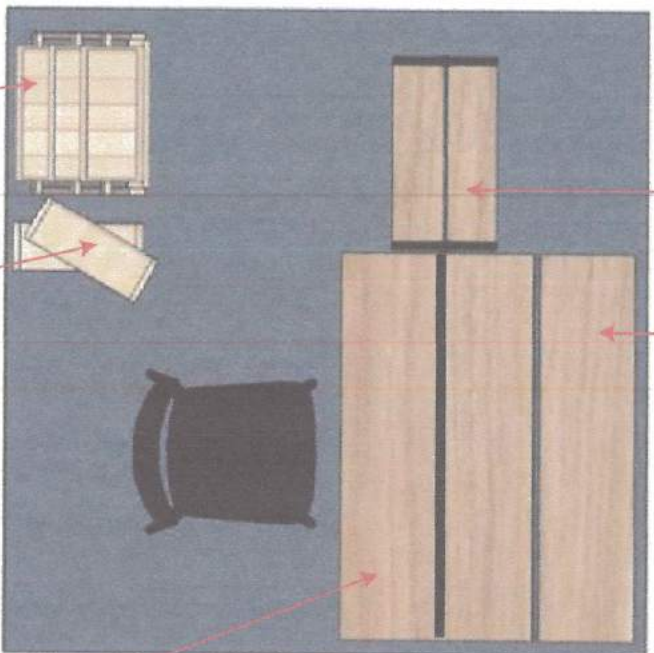

Crate
0.40m x 0.40m x 0.20m H

Foldable Ladder
0.50 x 1.10m H

0.60m x 0.20m H
Clip on signage holder
attached to display shelving
0.50m x 0.12m H fascia
sticker on back-to-back on
foam board hung with jute string

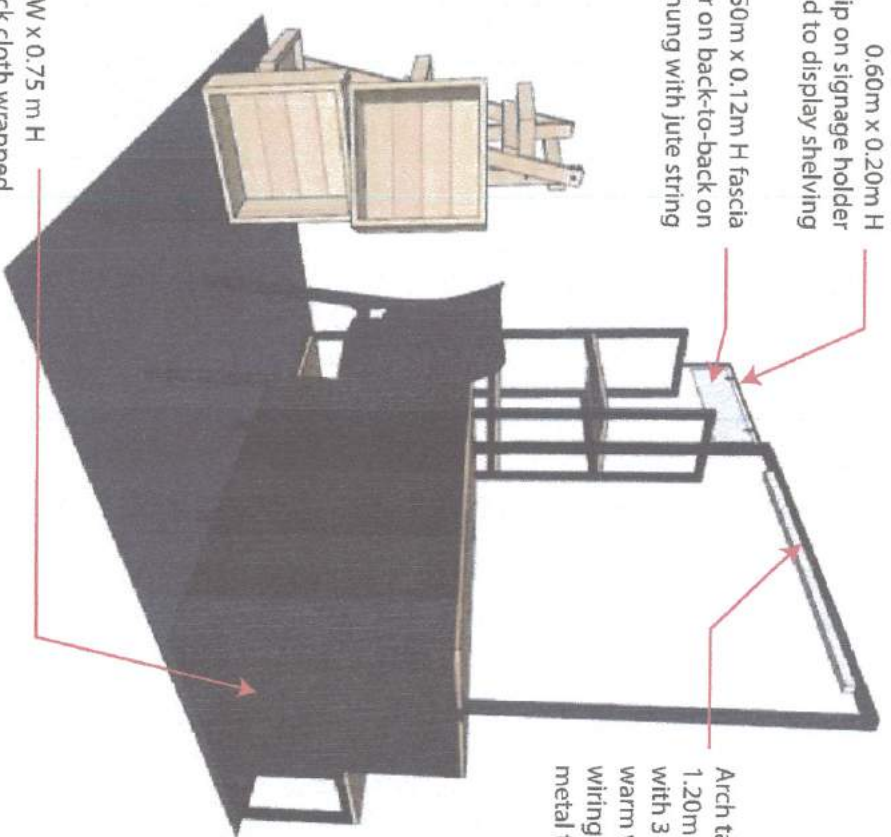

Arch table clamp
1.20m L x 1.08m H
with 3 ft Led T5 light;
warm white;
wiring inside the
metal tubing

Display table
1.20m L x 0.60m W x 0.75 m H
covered with black cloth wrapped
around the table, mounted
with velcro

2.0m x 2.0m BOOTH INCLUSIVE OF:

- 2.0m x 2.0m black carpet
- 1 convenience outlet
- 2 Crate 0.40m x 0.40m x 0.20m H
- 1 Foldable Ladder 0.50 x 1.10m H
- 1 Display bench 1.20m L x 0.30m W x 0.40m H
- 1 Display table 1.20m L x 0.60m W x 0.75 m H
- 1 Arch table clamp 1.20m L x 1.08m H with Led 3ft T5 light;
warm white; wiring inside the metal tubing
- 1 Display shelving 0.35m x 0.60m x 1.60m H
- 1 0.60m x 0.20m H Steel signage holder
- 1 0.50m x 0.12m H fascia sticker on back-to-back on foam board
- 1 black monoblock chair
- 1 waste bin
- 1 black booth cover with DTI BDTP logo

0.50m L x 0.50m H
logo graphics on foam board

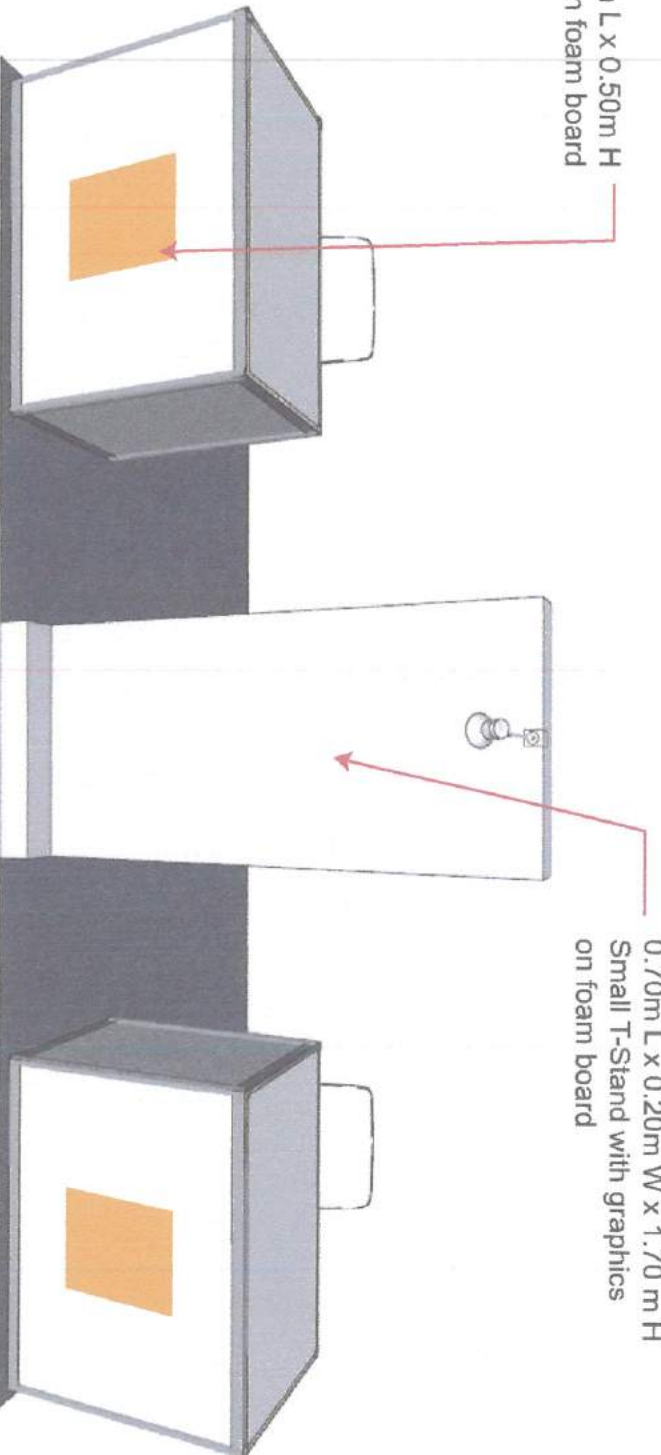

0.70m L x 0.20m W x 1.70 m H
Small T-Stand with graphics
on foam board

4.0m x 1.50m LOGISTICS AREA INCLUSIVE OF:

- 4.0m x 1.50m black carpet
- 2 convenience outlet
- 1 Low T-Stand 0.70m L x 0.20m W x 1.70 m H
- 2 0.50m L x 0.50m H logo graphics on foam board
- 1 long arm halogen light, warm white
- 2 Octanorm system table
- 1 black monoblock chair
- 1 waste bin

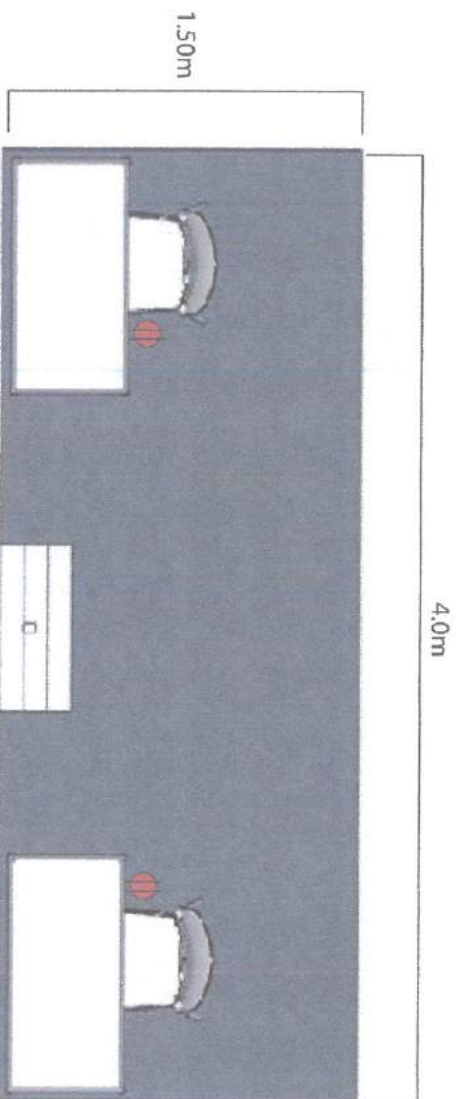

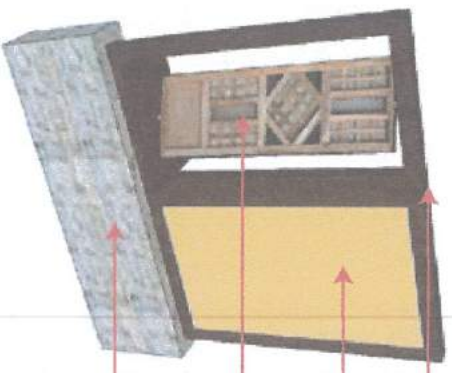
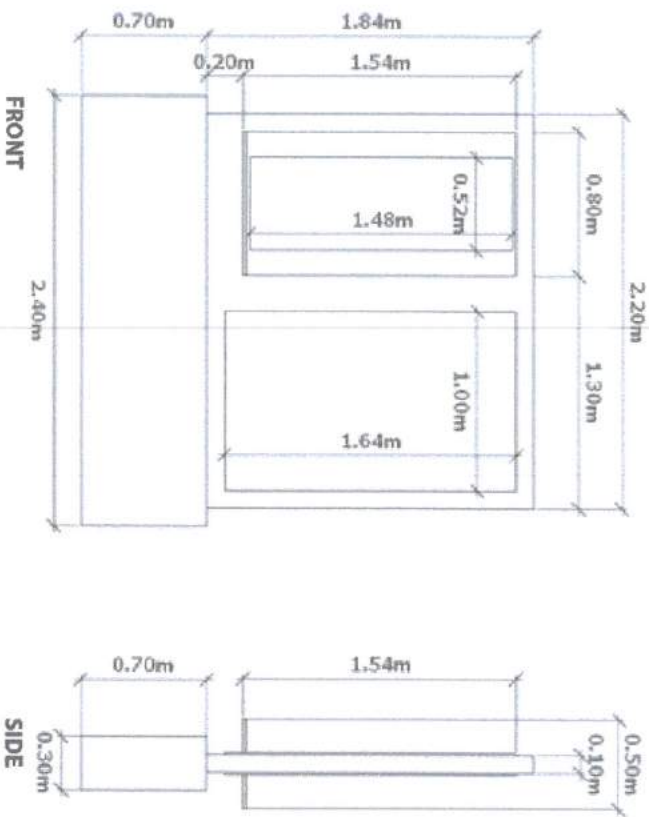

- 2.20m L x 0.10 m W x 1.84m H
frame in brown paint finish
- 1.0m W x 1.60m H
graphics on foamboard
- 0.52m W x 1.48m H
Capiz window with center pivot (swing)
- 2.40m L x 0.30 m W x 0.70m H
base with textured adode brick sticker

WINDOW CAPIZ STAND WITH MATTE STICKER GRAPHICS - 1 UNIT
2.40m L x 0.30 m W x 2.54m H

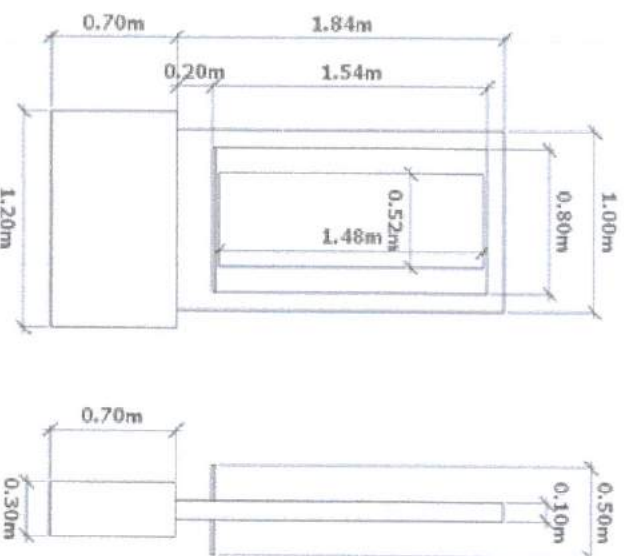

- 0.52m W x 1.48m H
Capiz window with center pivot (swing)
- 1.0m L x 0.10 m W x 1.84m H
frame in brown paint finish
- 1.20m L x 0.30 m W x 0.70m H
base with textured adode brick sticker

WINDOW CAPIZ STAND - 4 UNITS
(1.20m L x 0.30 m W x 2.54m H)

ARCH TABLE CLAMP - 25 PCS

1.20m L x 1.08m H
with Led 3ft T5 light; warm white;
wiring inside the metal tubing

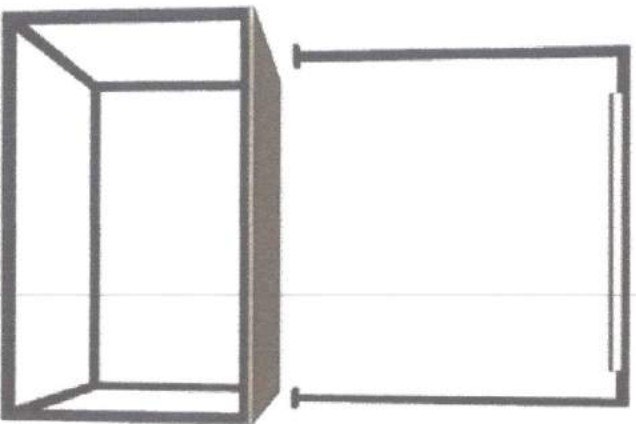

3/4" thk wood
sanded finish

DISPLAY SHELVING - 29 PCS

0.35m x 0.60m x 1.60m H
- 25 pcs for 2x2 booths
- 4 pcs for island setting

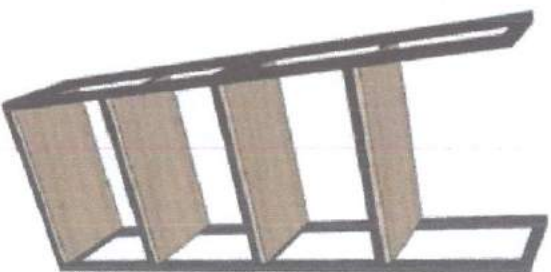

LOW DISPLAY TABLE - 3 PCS

0.60m L x 0.30m W x 0.60m H
- island setting

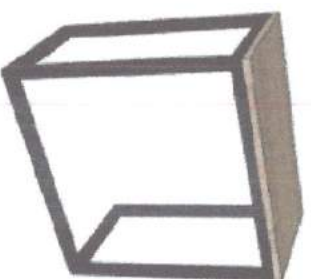

DISPLAY BENCH - 25 PCS

1.20m L x 0.30m W x 0.40 m H

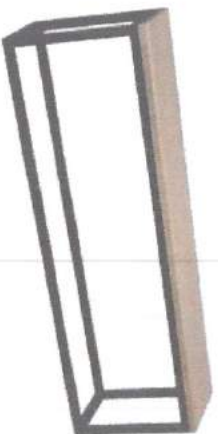

CLIP ON SIGNAGE HOLDER - 29 PCS

0.60m x 0.20m H
- 25 pcs for 2x2 booths
- 4 pcs for island setting



**FASCI SIGNAGE ON FOAM BOARD
HUNG WITH JUTE STRING - 29 PCS**

0.60m x 0.20m H
- 25 pcs for 2x2 booths
- 4 pcs for island setting

T-STAND - 4 PCS

1.20m l x 0.30m w x 2.40m h
-2 pcs for registration area
-2 pcs near stairs going to landmark and sm



***MATERIAL / FINISH:**

- 3/4" thk wood sanded finish
- 1" x 1" thk metal tubing painted in black (fire retardant paint)

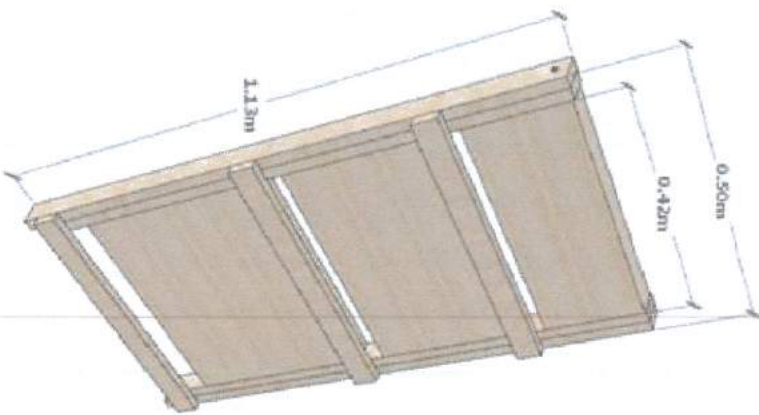

FOLDABLE LADDER - 25 PCS
0.50 x 1.10m H

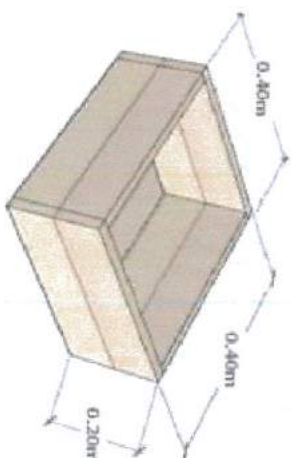
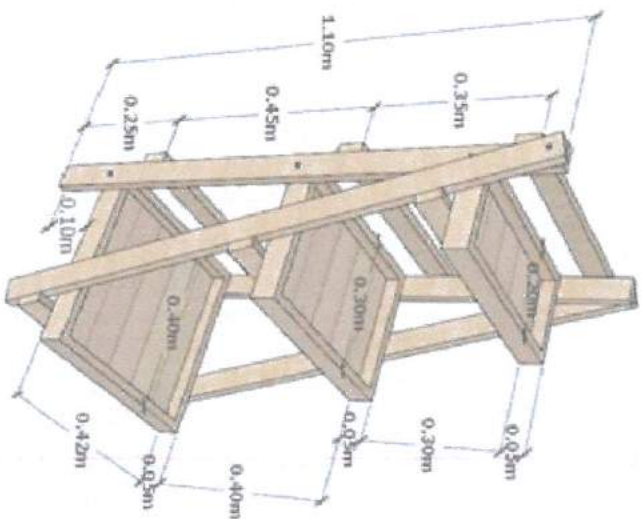

CRATE- 50 PCS
0.40m x 0.40m x 0.20m H

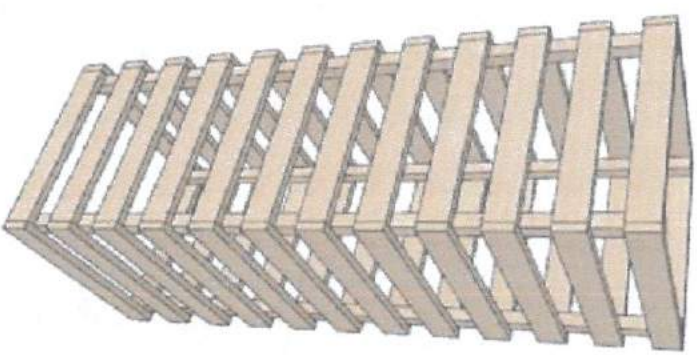

WOODEN PILLARS - 10 PCS
0.75m W x 0.75m L x 2.40m H
- 6 pcs Main Entrance from G4
- 4 pcs Entrance / Exit from Palm Drive



CAPIZ STAR STRING LIGHTS
hanged on pillars



SMALL T-STAND - 1 PC
0.70m L x 0.20m W x 1.70 m H
-logistics area



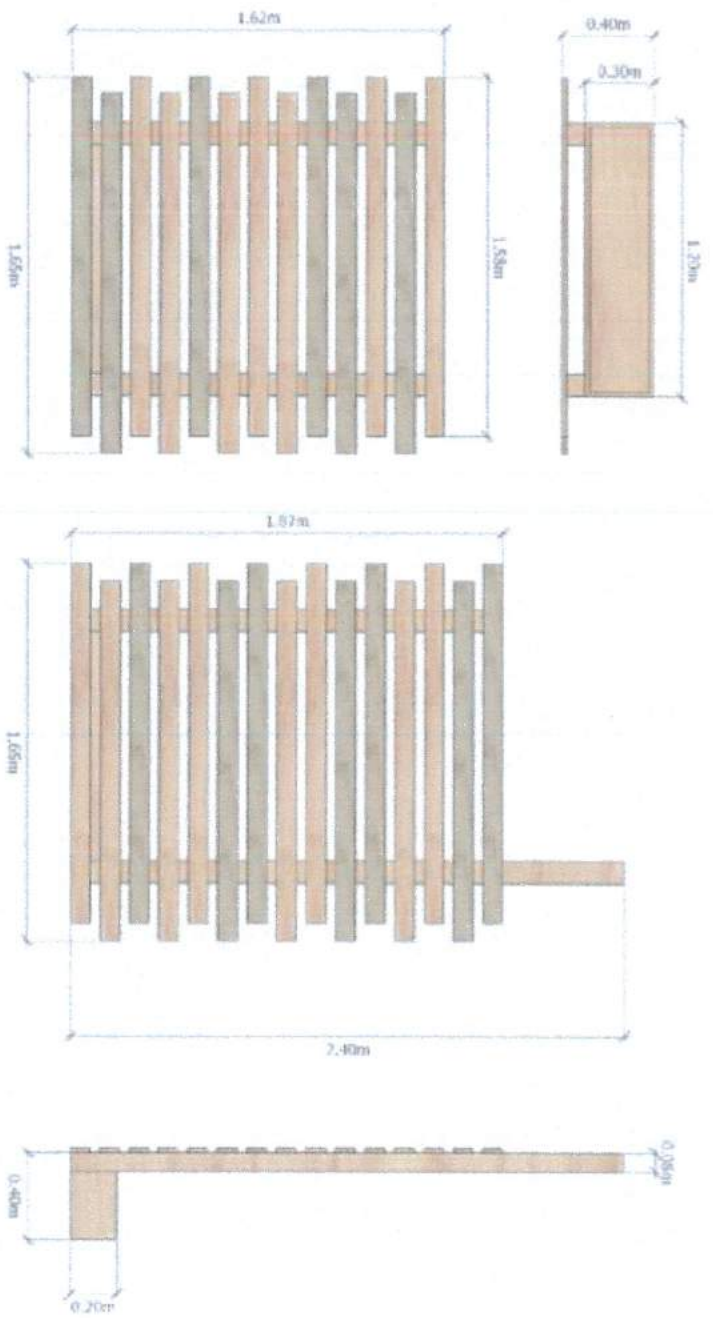
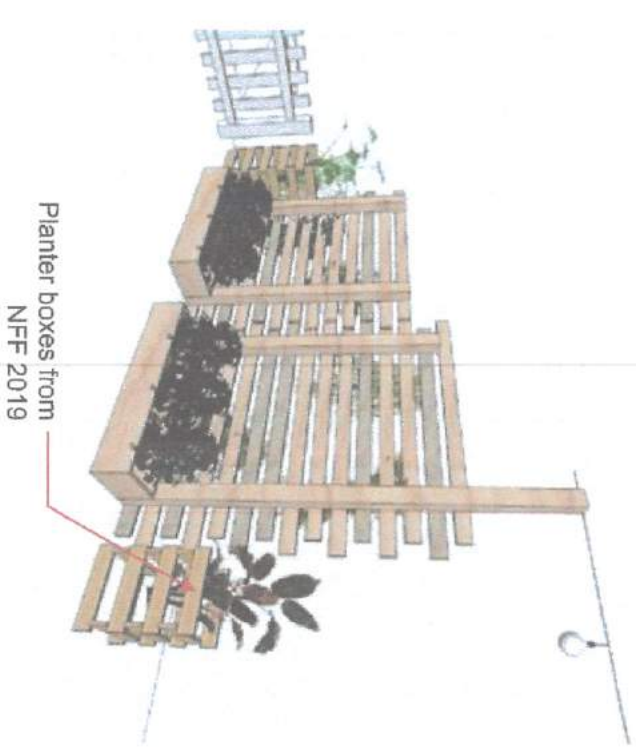
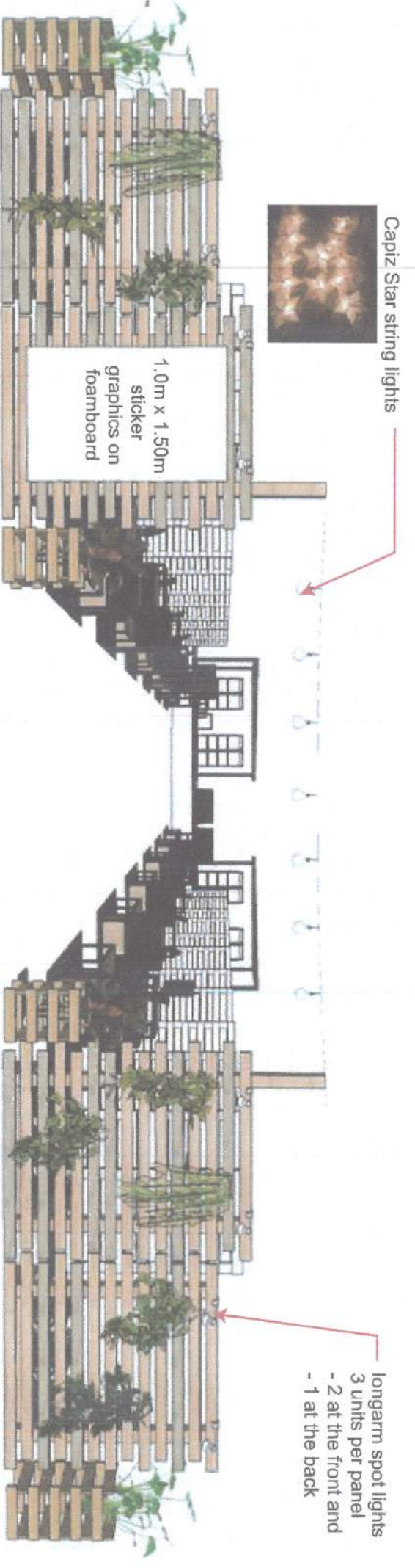

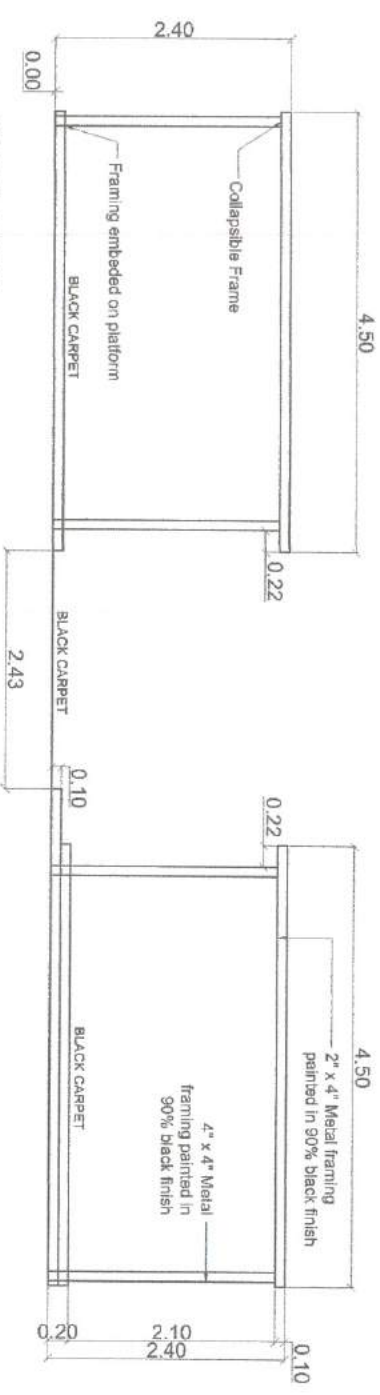
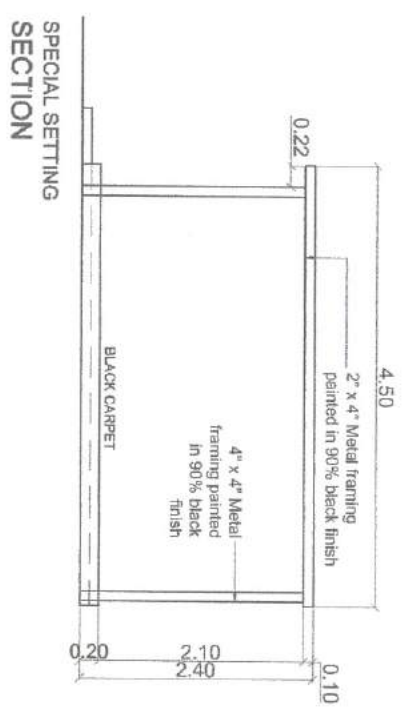
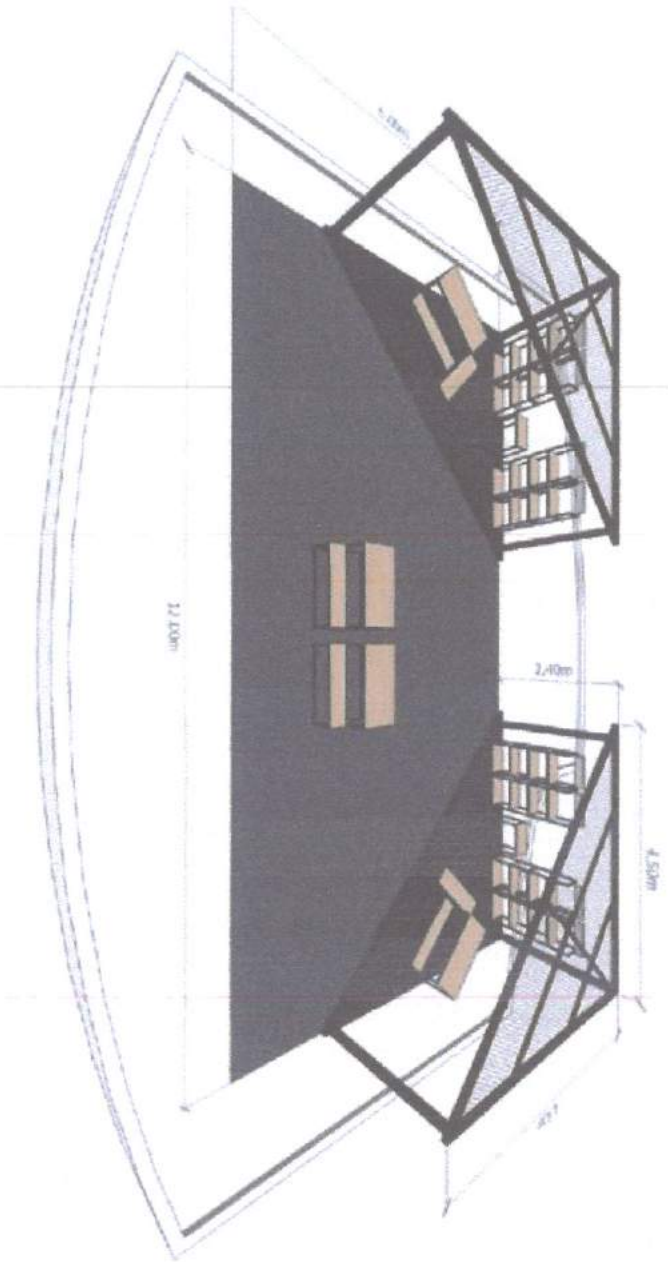

- INCLUSIVE OF:**
- 12.0m x 6.0m black carpet
 - 2 units of Existing structure 4.50m x 4.50m x 2.40m H
 - 2 units of 4.50m x 4.50mx 0.10m H triangular platform in black carpet
 - 8 convenience outlet
 - 12 units black tracklights, warm white
 - 8 Display shelving 0.35m x 0.60m x 1.60m H
 - 4 Display table 1.20m L x 0.60m W x 0.75m H
 - 8 Display bench 1.20m L x 0.30m W x 0.40m H
 - 2 Low Display table 0.60m L x 0.30m W x 0.60m H
 - 2 waste bins
 - 7 black booth cover with DTI BDTP logo

DTI-BAGSAKAN November 2020
 ACTIVITY CENTER PALM DRIVE CHRISTMAS SETTING
 AS OF 11 NOVEMBER

Refurbish Pallet Backwall
with shelves; painted in white

Fascia Sticker graphics
on foam board

Low Display Shelving
0.50m L x 0.60m W x 1.0m H
(kapetir'ya)

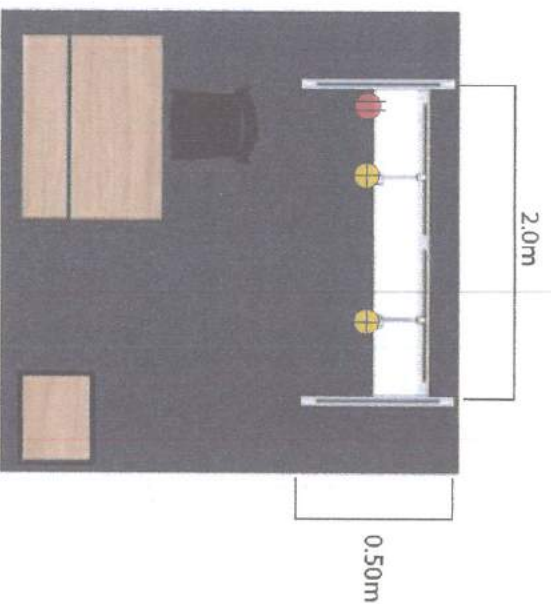

1.83m

3.0m x 3.0m BOOTH INCLUSIVE OF:

- 3.0m x 3.0m black carpet
- 1 convenience outlet
- 1 Display bench 1.20m L x 0.30m W x 0.40m H
- 1 Display table 1.20m L x 0.60m W x 0.75 m H
- 1 Low Display shelving 0.50m L x 0.60m W x 1.0m H
- 1 0.50m x 0.12m H fascia sticker on back-to-back on foam board
- 2 pcs long arm halogen light, warm white
- 1 black monoblock chair
- 1 waste bin
- 1 black booth cover with DTI BDTP logo

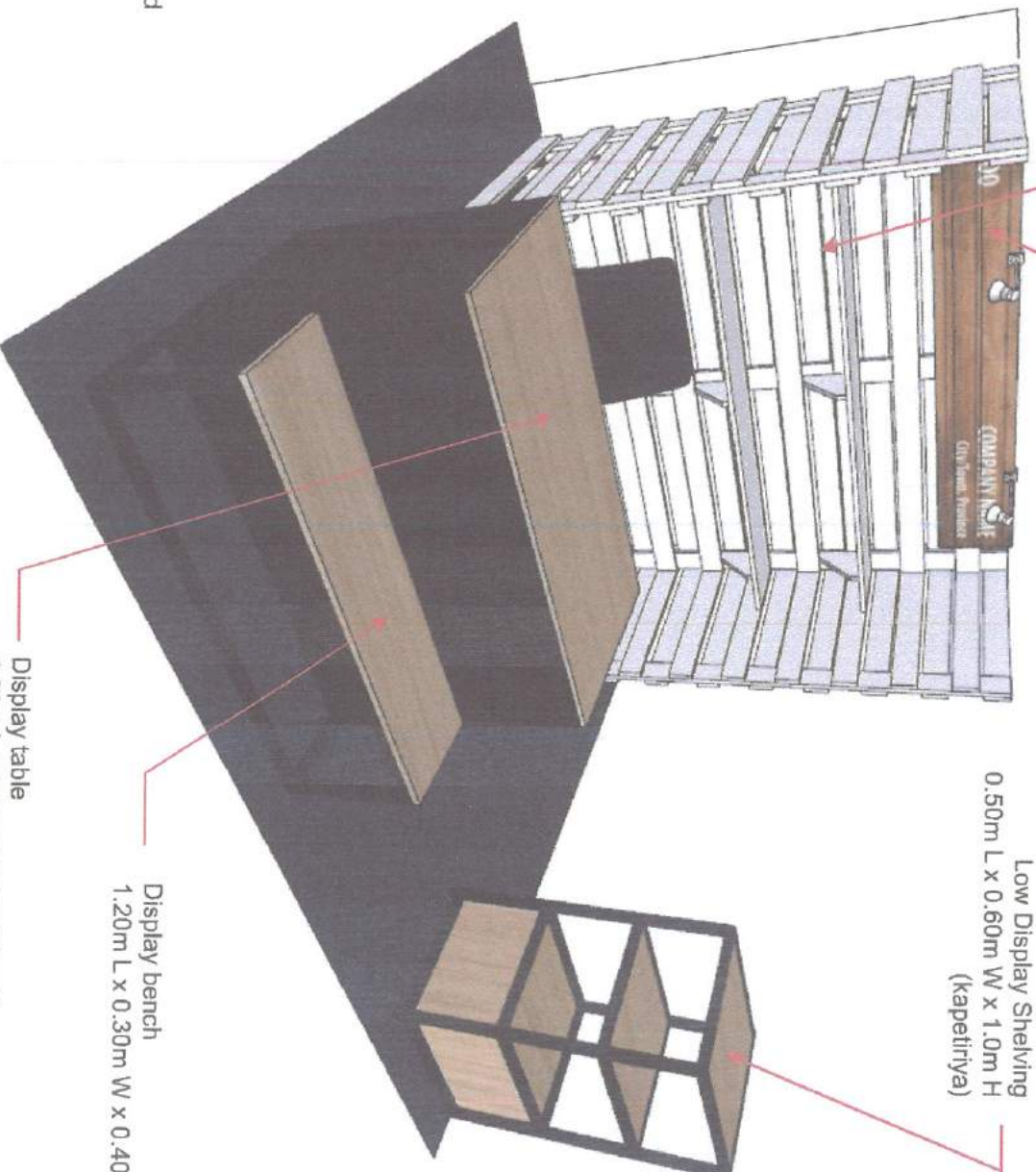

Display table
1.20m L x 0.60m W x 0.75 m H
covered with black cloth wrapped
around the table, mounted
with velcro

Display bench
1.20m L x 0.30m W x 0.40m H

DISPLAY TABLE - 16 PCS

- 1.20m L x 0.60m W x 0.75 m H
- 12 pcs for 3 x 3 booths
- 4 pcs for christmas setting

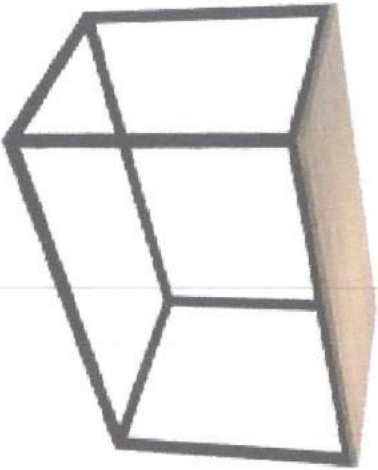

DISPLAY BENCH - 20 PCS

- 1.20m L x 0.30m W x 0.40 m H
- 12 pcs for 3 x 3 booths
- 8 pcs for christmas setting

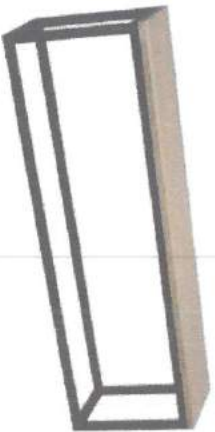

DISPLAY SHELVING - 8PCS

- 0.35m x 0.60m x 1.60m H
- for christmas setting

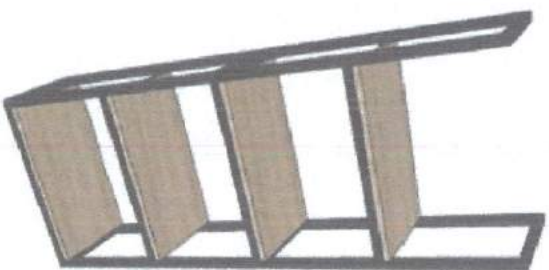

LOW DISPLAY TABLE - 2 PCS

- 0.60m L x 0.30m W x 0.60m H
- 2 pcs for christmas setting

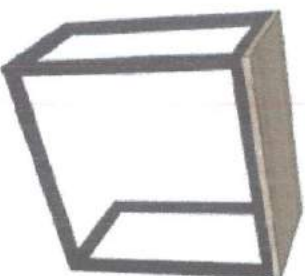

LOW DISPLAY SHELVING- 12PCS

- 0.50m L x 0.60m W x 1.0m H
- for 3 x 3 booths

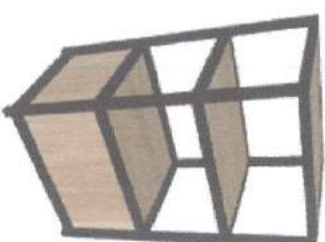

***MATERIAL / FINISH:**

- 3/4" thk wood sanded finish
- 1" x 1" thk metal tubing painted in black (fire retardant paint)

PALLET WHITE BACKWALL - 12 SETS

- 0.60m L x 0.30m W x 0.60m H
- painted in white (fire retardant)

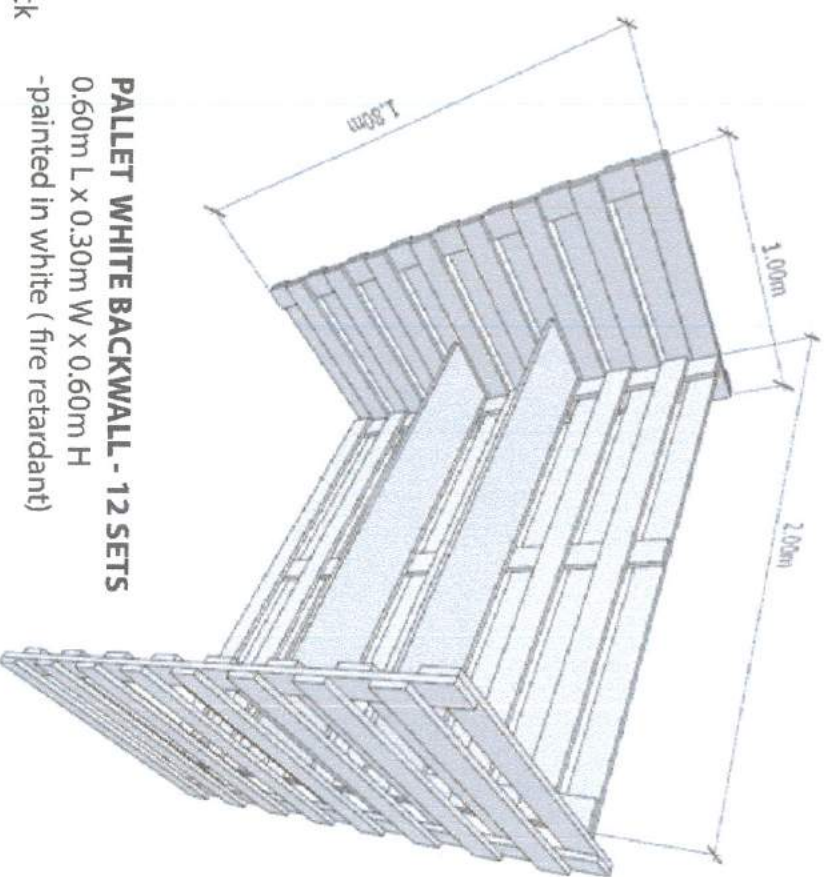

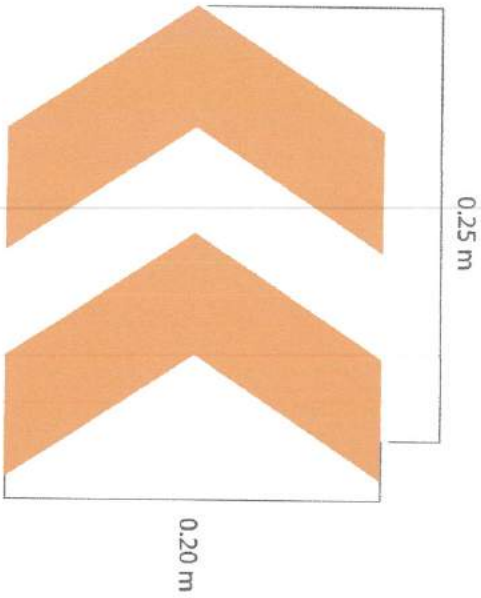

DIRECTIONAL FLOOR STICKER- 86 PCS



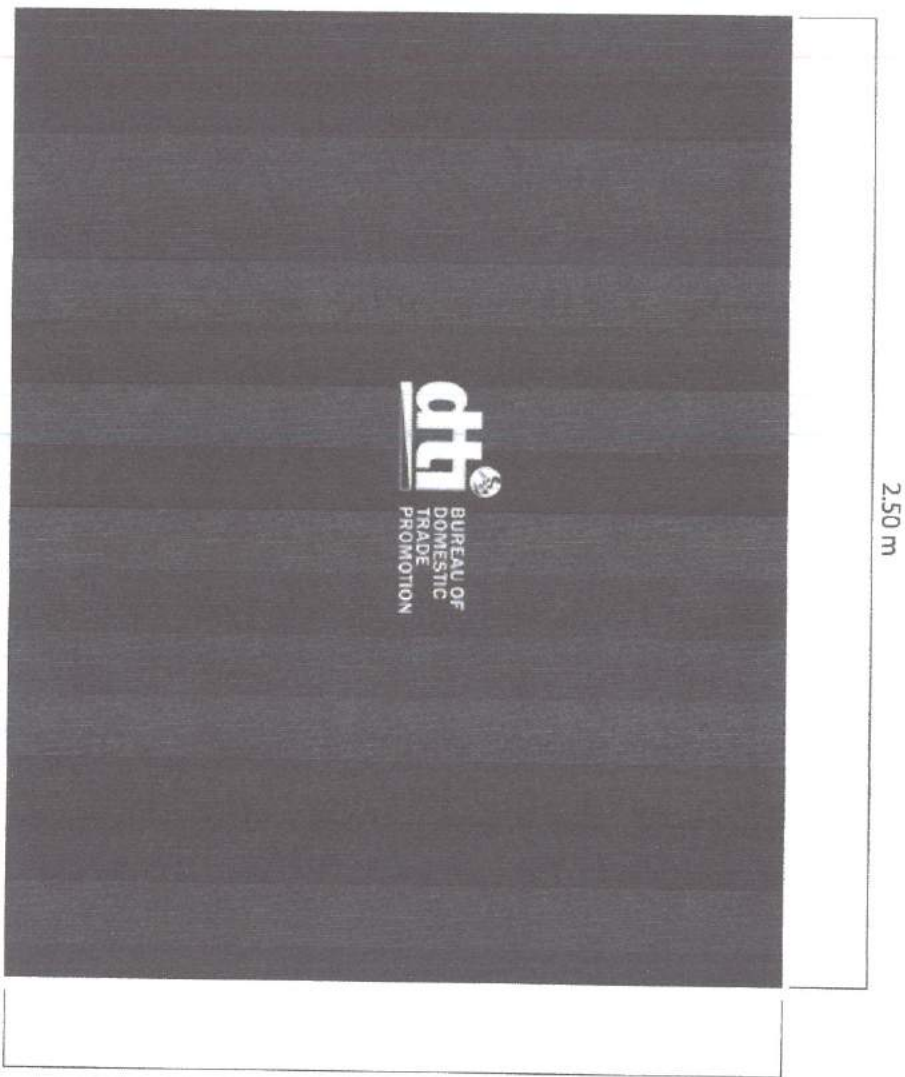



- 0.25 m L x 0.20 m W (Orange / verify approved color)
- 56 pcs for main activity center
 - 30 pcs for palm drive

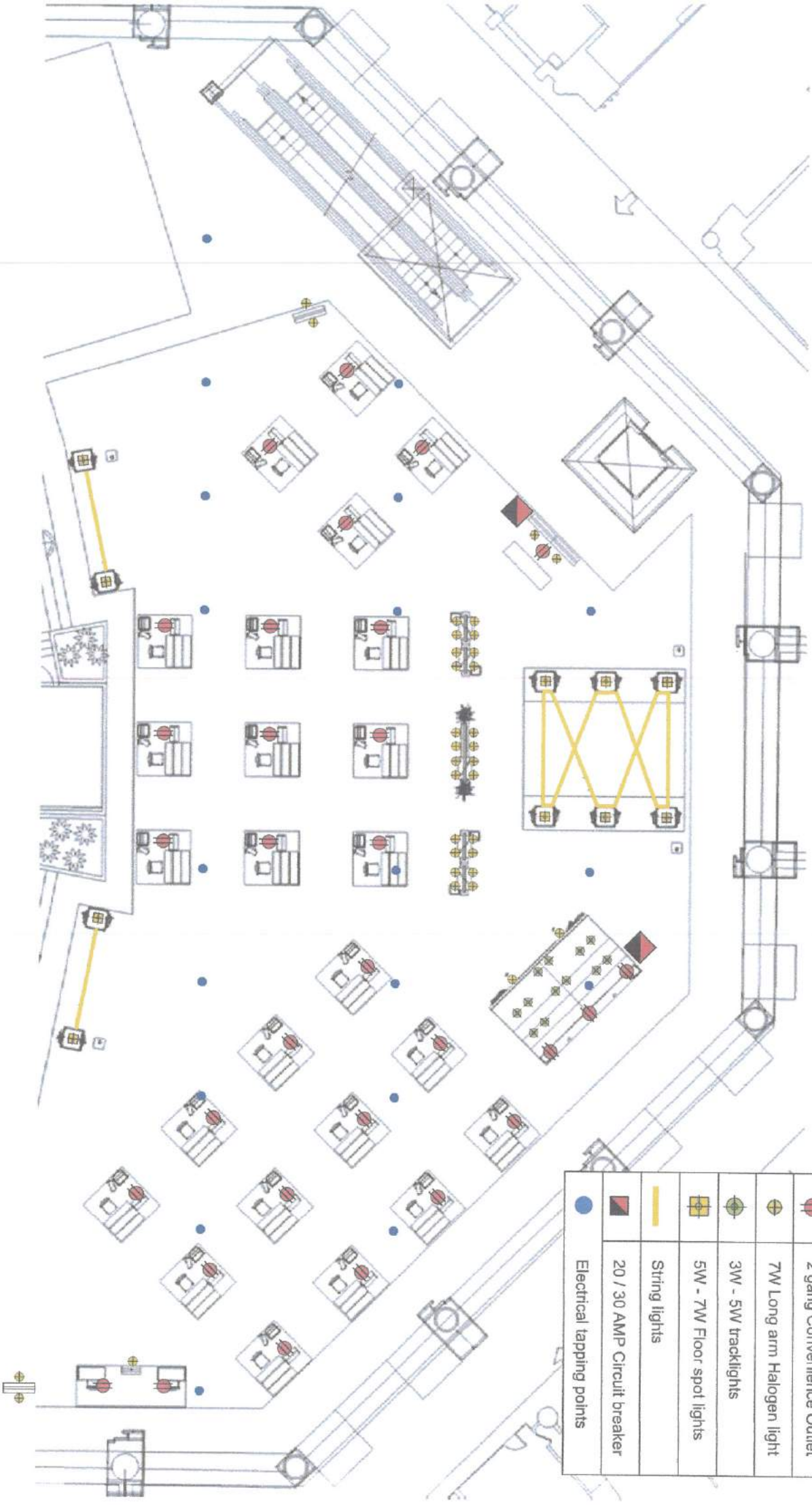

BLACK BOOTH COVER WITH DTI BDTP LOGO - 50 PCS

- 2.50 m L x 2.0 m W
- 25 pcs for 2 x 2 booths
 - 12 pcs for 3 x 3 booths
 - 7 pcs for christmas setting
 - 6 pcs for island setting



LEGEND	
	2 gang Convenience Outlet
	7W Long arm Halogen light
	3W - 5W tracklights
	5W - 7W Floor spot lights
	String lights
	20 / 30 AMP Circuit breaker
	Electrical tapping points

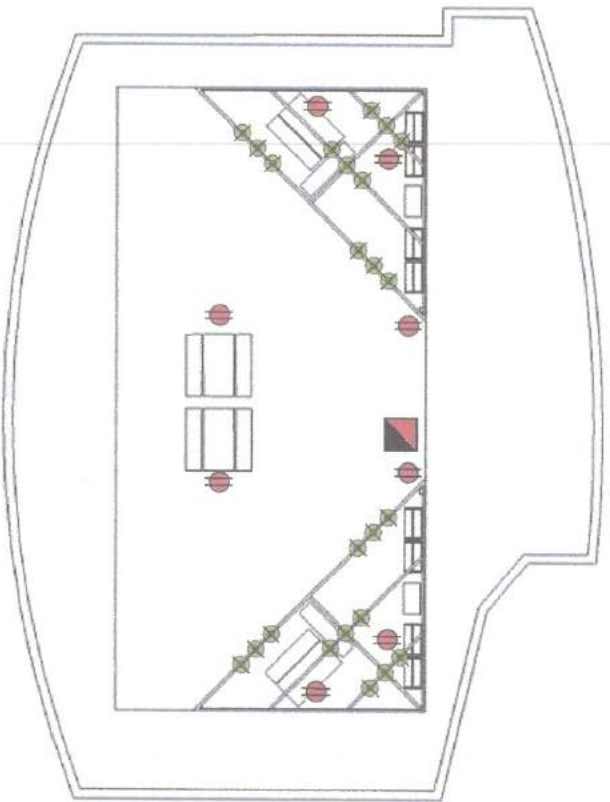

LEGEND	
	2 gang Convenience Outlet
	7W Long arm Halogen light
	3W - 5W tracklights
	5W - 7W Floor spot lights
	String lights
	20 / 30 AMP Circuit breaker
	Electrical tapping points

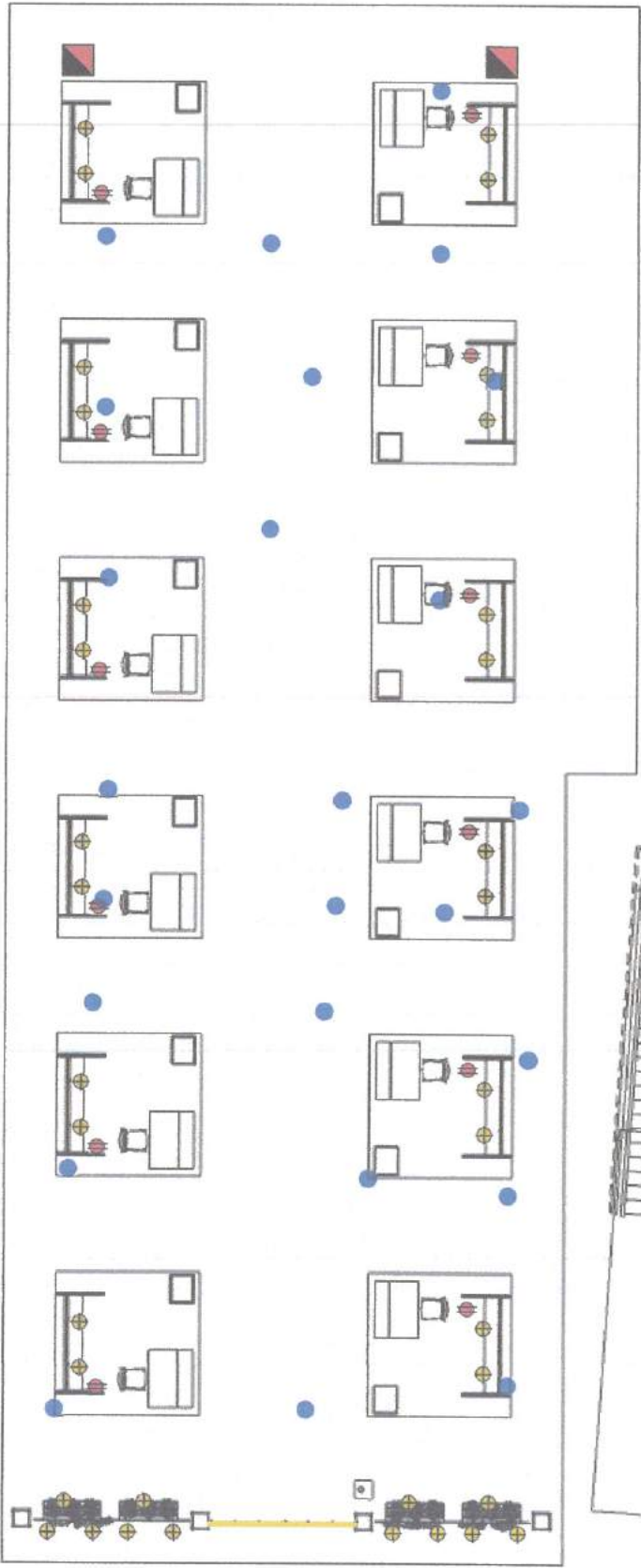

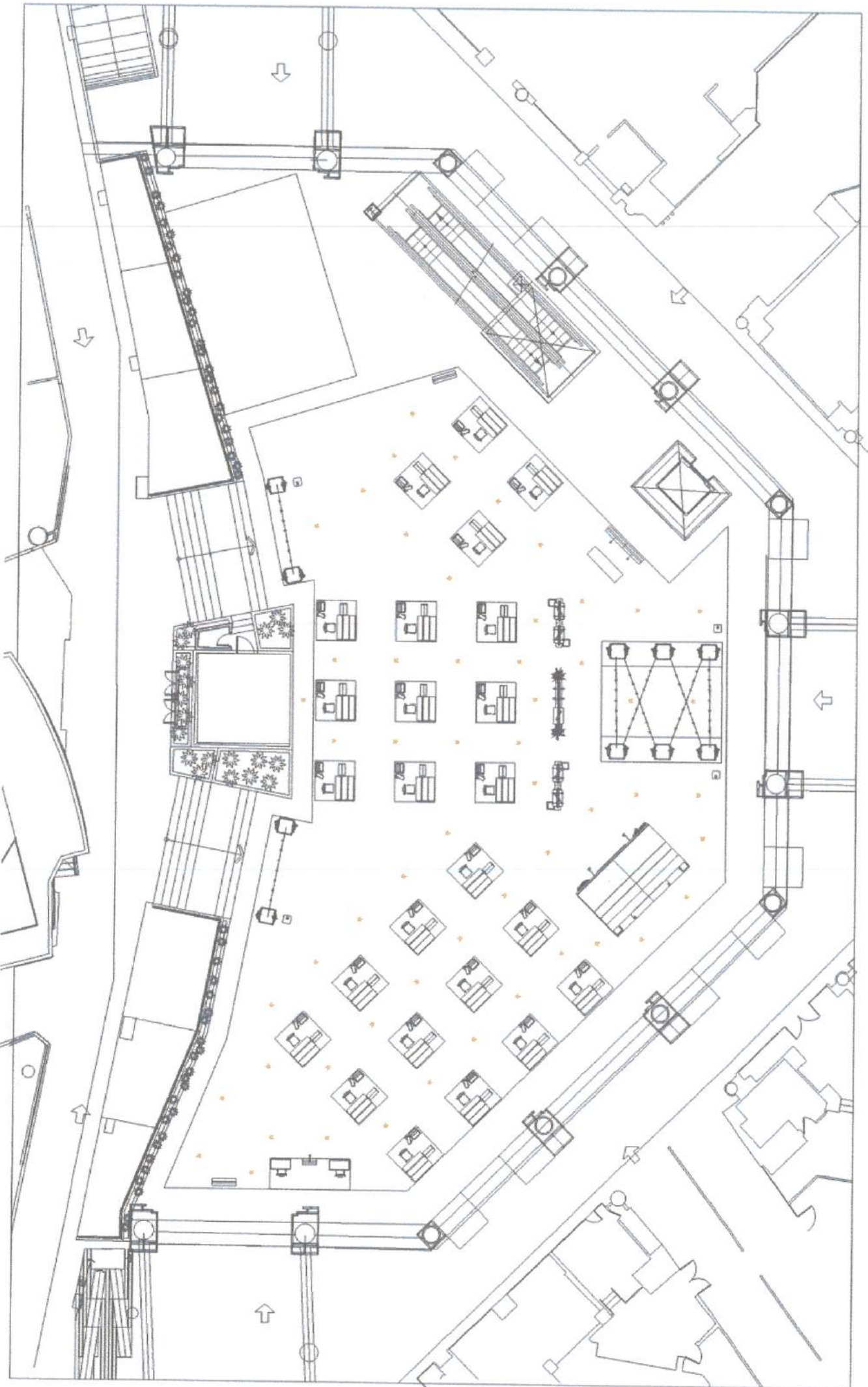

DTI-BAGSAKAN November 2020
ACTIVITY CENTER LAYOUT _ TRAFFIC FLOW
AS OF 08 NOVEMBER

56 PCS DIRECTIONAL FLOOR STICKER

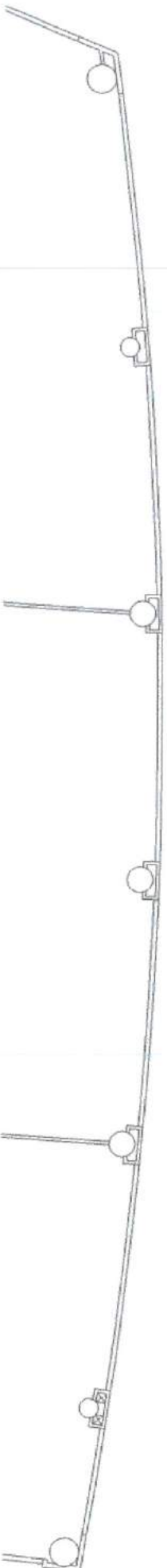
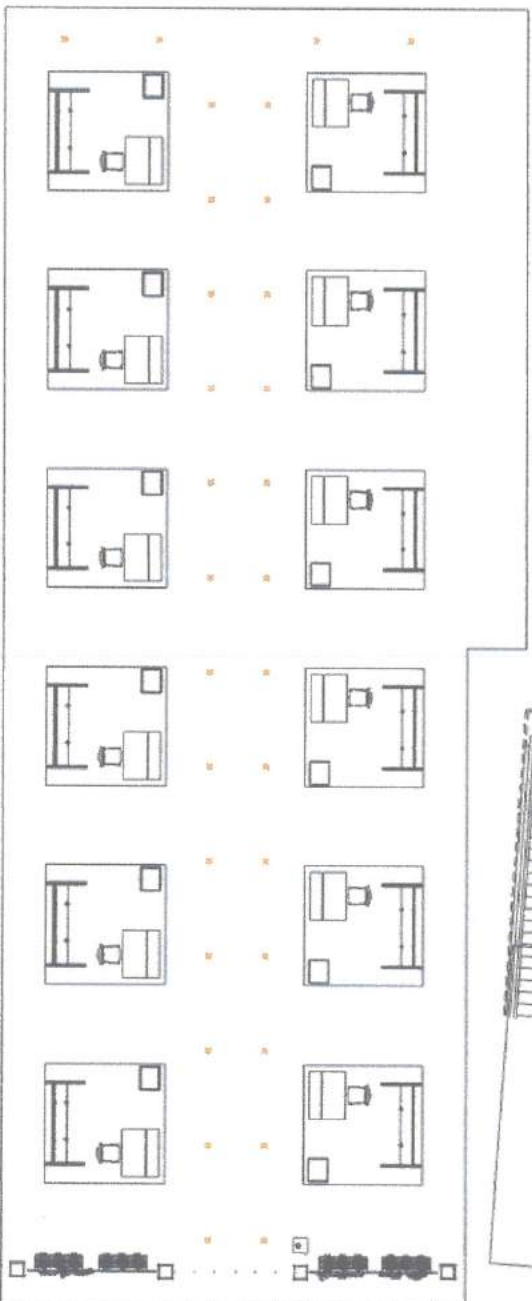
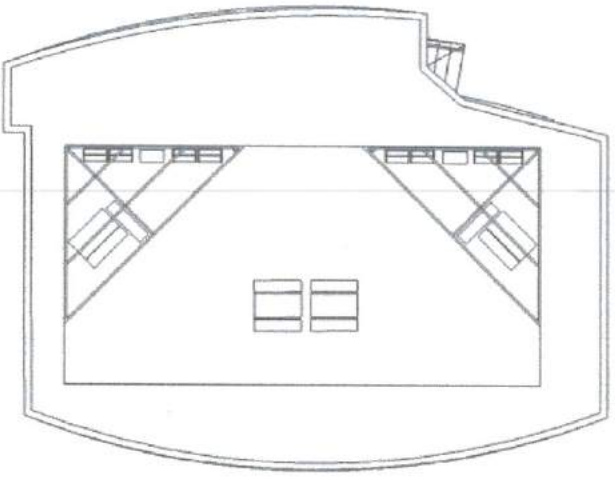
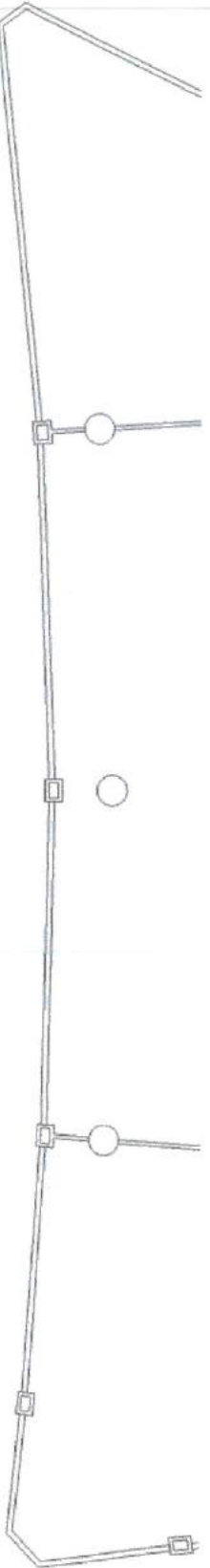

30 PCS DIRECTIONAL FLOOR STICKER